



QUICK START GUIDE

THANK YOU FOR PURCHASING YOUR NEW EUREKA VACUUM!

AS1100-1109 Series
With cord rewind

Please take a few moments to read this Quick Start Guide. It is designed to help you assemble your vacuum easily.

To view our "How to Assemble" demo, visit www.eureka.com/suctionseal/assembly

If you have questions about your new vacuum, please contact our customer service helpline at **1-800-282-2886**. We're here to help!

Helpline Hours:

8 a.m. to 7:30 p.m. (CST), Monday - Friday

10 a.m. to 6:30 p.m. (CST), Saturday - Sunday

eureka!
Invented for the way you clean™

STEP 1

What's in the carton

No screws or tools required!

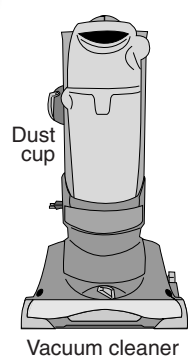

Important Safeguards

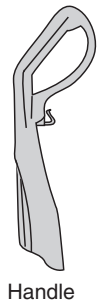

Handle

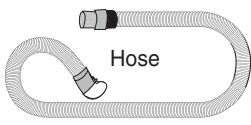

Hose

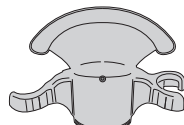

Carry handle

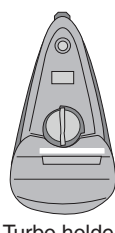

Turbo holder



Dusting brush

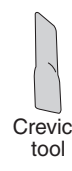

Crevice tool

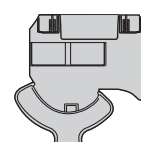

Lower hose retainer

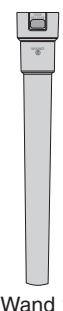

Wand 1

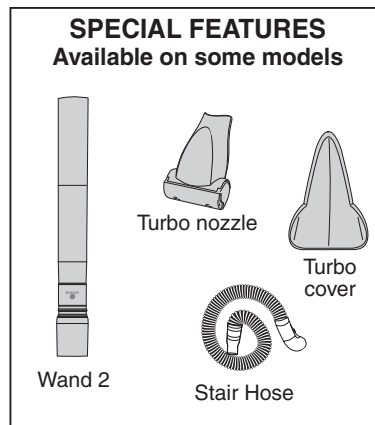

SPECIAL FEATURES
Available on some models

STEP 2

Easy assembly

PLEASE READ ALL INSTRUCTIONS BEFORE USING THIS VACUUM CLEANER.
Moving parts! Assemble the vacuum cleaner before using.

Follow 1-11 in order to ensure proper assembly.

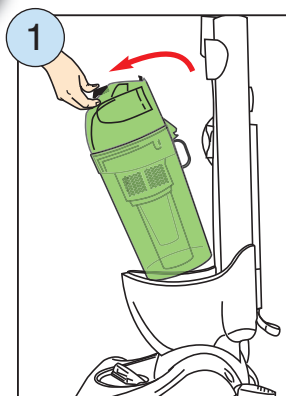

Remove dust cup to assemble vacuum.

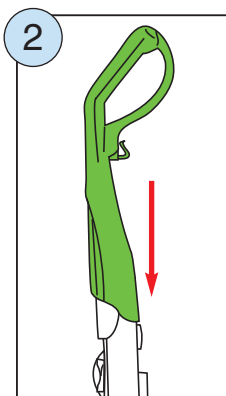

Place handle on vacuum; push down to snap in place.

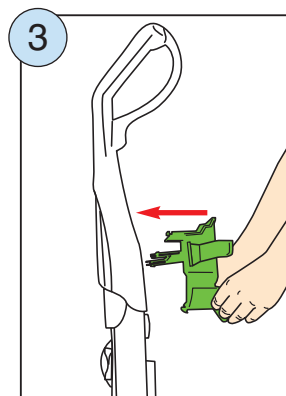

Slide carry handle into back of handle. Snap into place.

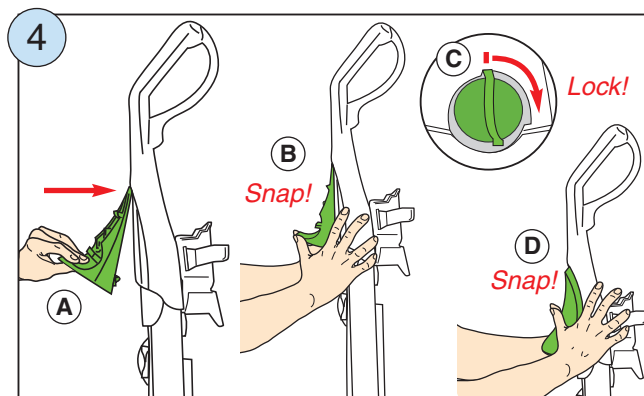

Insert top tab **A** turbo holder into handle. Place thumbs on each side and snap bottom corners **B** into place. Turn **C** knob to lock. Store turbo nozzle in holder. **Some models:** Snap **D** turbo cover straight on from front to back.

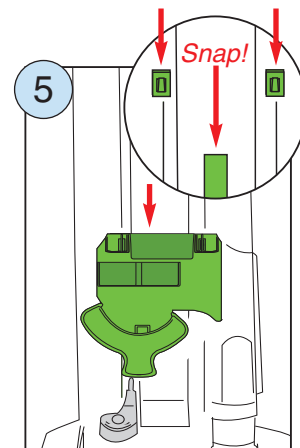

Place lower hose retainer in slots on back of vacuum. Push down to snap into place.

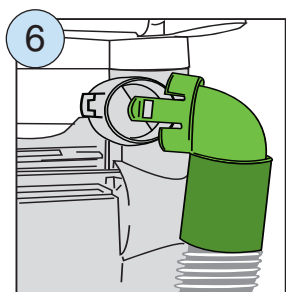

To install hose connector, align tab at right and snap on at left.

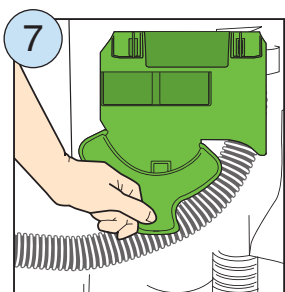

Pull out bottom of lower hose retainer and position hose.

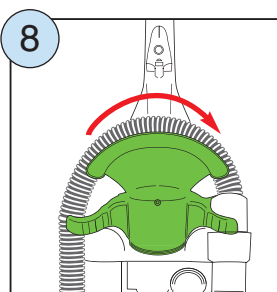

Place hose over carry handle.

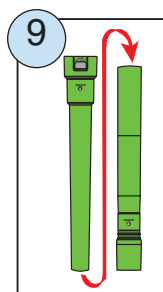

Some models: Slip wand 2 over wand 1.

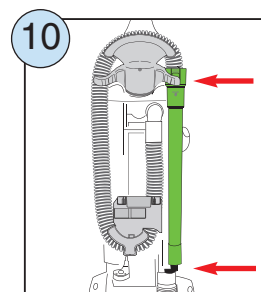

Push wand 1 onto end of hose. Place over bottom hook; snap in at top.

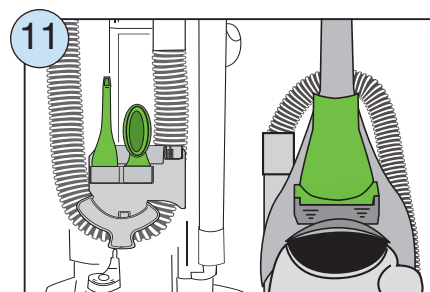

Store dusting brush and crevice tool on back of vacuum. Store turbo nozzle in holder (tools vary by model).

STEP 3

How to use and clean your vacuum

Power switch is marked **Ⓛ** for on-off.

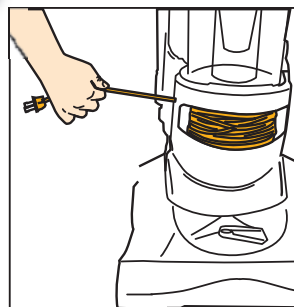

Pull out cord to desired length. Do not pull past red line; push cord into cord clip.

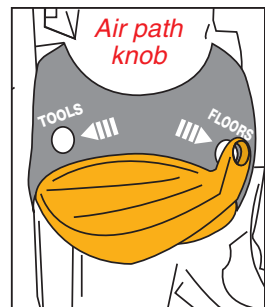

To vacuum floors, turn air path knob to 'floors.'

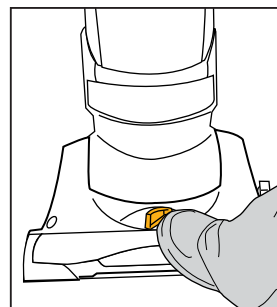

Use foot to adjust height for carpet or bare floors.

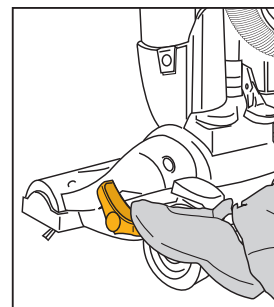

Brush roll on/off lever: Turn brush roll lever on for carpet; turn brush roll lever off for bare floors and tools.

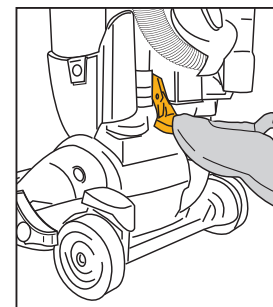

Step on power switch to turn on; step on again to turn off.

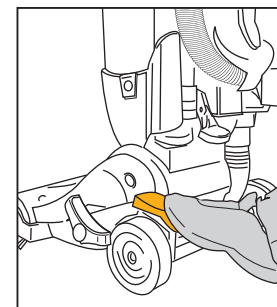

Step on handle release to lower handle into position.

Empty dust cup after each use.

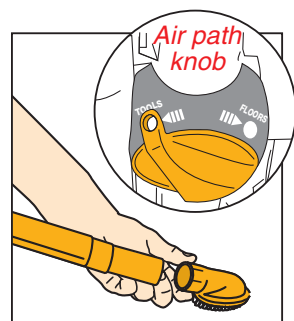

Attach tool to end of wand. Turn air path knob to 'tools.'

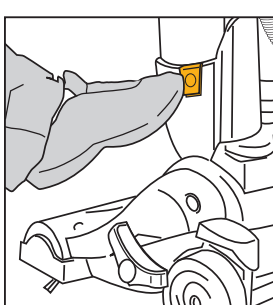

Press switch to rewind cord.

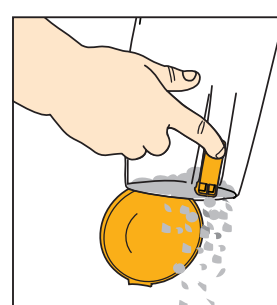

Remove dust cup; press lever to release bottom lid.

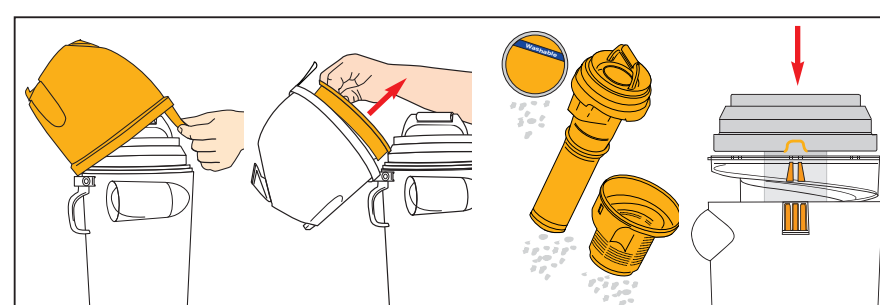

Pull filter latch to release cover. Lift out foam filter and shake off dust. Lift out filter tube with screen; shake off dust. Reinstall filters and close cover.

Free Manuals Download Website

<http://myh66.com>

<http://usermanuals.us>

<http://www.somanuals.com>

<http://www.4manuals.cc>

<http://www.manual-lib.com>

<http://www.404manual.com>

<http://www.luxmanual.com>

<http://aubethermostatmanual.com>

Golf course search by state

<http://golfingnear.com>

Email search by domain

<http://emailbydomain.com>

Auto manuals search

<http://auto.somanuals.com>

TV manuals search

<http://tv.somanuals.com>