



# Gas Log Patio Hearth Model 5076 Series

## *INSTRUCTIONS FOR USE*

U.S. and other Patents Pending

© 2001 The Coleman Company, Inc.  
[www.coleman.com](http://www.coleman.com)



### **IMPORTANT**

Read this manual carefully before assembling, using or servicing this heater. Keep this manual for future reference. If you have questions about assembly, operation, servicing or repair of this heater, please call Coleman at 1-800-835-3278 or TDD: 316-832-8707. In Canada call 1-800-387-6161.



CSA International  
Requirement 4.96 U.S.

Propane Tank  
Not Included

**Outdoor use only**

## Contents

General Safety Information  
Assembly  
Leak Check  
Operation  
Storage  
Maintenance  
Troubleshooting  
Service  
Warranty  
Replacement Parts

## General Safety Information

This manual contains important information about the assembly, operation and maintenance of this fireplace. General safety information is presented in these first few pages and is also located throughout the manual. Particular attention should be paid to information accompanied by the safety alert symbols: "⚠ DANGER", "⚠ WARNING", "⚠ CAUTION".

Keep this manual for future reference and to educate new users of this product. This manual should be read in conjunction with the labeling on the product.

Safety precautions are essential when any mechanical or propane fueled equipment is involved. These precautions are necessary when using, storing, and servicing. Using this equipment with the respect and caution demanded will reduce the possibilities of personal injury or property damage.

The following symbols shown below are used extensively throughout this manual. Always heed these precautions, as they are essential when using any mechanical or fueled equipment.

### ⚠ DANGER

DANGER indicates an imminently hazardous situation which, if not avoided, will result in death or serious injury.

### ⚠ WARNING

WARNING indicates a potentially hazardous situation which, if not avoided, could result in death or serious injury.

### ⚠ CAUTION

CAUTION indicates a potentially hazardous situation which, if not avoided, may result in minor or moderate personal injury, or property damage.

## FOR YOUR SAFETY

If you smell gas:

1. Shut off gas to the appliance.
2. Extinguish open flame.
3. If odor continues, immediately call your gas supplier.

## General Safety Information *cont.*

### FOR YOUR SAFETY

**Do not store or use gasoline or other flammable vapor and liquids in the vicinity of this or any other appliance.**

**⚠ WARNING: For Outdoor Use Only**

### ⚠ WARNING

**Improper installation, adjustment, alteration, service or maintenance can cause injury or property damage. Read the Installation, Operating, & Maintenance Instructions thoroughly before installing or servicing this equipment**

### ⚠ DANGER

Failure to comply with the precautions and instructions provided with this fireplace can result in death, serious bodily injury and property loss or damage from hazards of fire, explosion, burn, asphyxiation, and/or carbon monoxide poisoning.

Only persons who can understand and follow the instructions should use or service this fireplace.

If you need assistance or fireplace information such as an instruction manual or labels, contact the Coleman Co., Inc.

### ⚠ DANGER



#### • EXPLOSION - FIRE HAZARD

- Keep solid combustibles, such as building materials, paper or cardboard, a safe distance away from the fireplace as recommended by the instructions.
- Provide adequate clearances around air openings into the combustion chamber.
- Never use the fireplace in spaces which do or may contain volatile or airborne combustibles, or products such as gasoline, solvents, paint thinner, dust particles or unknown chemicals.
- During operation, this product can be a source of ignition. Keep fireplace area clear and free from combustible materials, gasoline, paint thinner, cleaning solvents and other flammable vapors and liquids. Do not use fireplace in areas with high dust content. Minimum clearances from combustible materials: two feet from the sides & eight feet from the top.

### ⚠ WARNING

We cannot foresee every use which may be made of this fireplace. **Check with your local fire safety authority if you have questions about use.**

Other standards govern the use of fuel gases and heat producing products for specific uses. Your local authorities can advise you about these.

If no local codes exist, follow National Fuel Gas Code, ANSI Z223.1. In Canada, installation must conform to local codes. If no local codes exist, follow the current National standards of CANADA CAN/CGA-B 149.2.

## ⚠ DANGER



### • CARBON MONOXIDE HAZARD

- This fireplace is a combustion appliance. All combustion appliances produce carbon monoxide (CO) during the combustion process. This product is designed to produce extremely minute, non-hazardous amounts of CO if used and maintained in accordance with all warnings and instructions. Do not block air flow into or out of the fireplace.
- Carbon Monoxide (CO) poisoning produces flu-like symptoms, watery eyes, headaches, dizziness, fatigue and possibly death. You can't see it and you can't smell it. It's an invisible killer. If these symptoms are present during operation of this product **get fresh air immediately!**
- **For outdoor use only.**
- **Never use inside house, or other unventilated or enclosed areas. This fireplace consumes air (oxygen). Do not use in unventilated or enclosed areas to avoid endangering your life.**

## ⚠ WARNING

- This product is fueled by propane gas. Propane gas is invisible, odorless, and flammable. An odorant is normally added to help detect leaks and can be described as a "rotten egg" smell. The odorant can fade over time so leaking gas is not always detectable by smell alone.
- Propane gas is heavier than air and leaking propane will sink to the lowest level possible. It can ignite by ignition sources including matches, lighters, sparks or open flames of any kind many feet away from the original leak. Use only propane gas set up for vapor withdraw.
- Propane gas should be stored or used in compliance with local ordinances and codes or with ANSI/NFPA 58. Turn off propane when not in use.

### CALIFORNIA PROPOSITION 65:

WARNING: Propane and byproducts of combustion of propane contain chemicals known to the state of California to cause cancer, birth defects, or other reproductive harm.

## ⚠ DANGER



### • EXPLOSION - FIRE HAZARD

- Never store propane near high heat, open flames, pilot lights, direct sunlight, other ignition sources or where temperatures exceed 120 degrees F (49°C).
- Propane is heavier than air and can accumulate in low places. If you smell gas, leave the area immediately.
- Never install or remove propane tank while fireplace is lighted, near flame, pilot lights, other ignition sources or while fireplace is hot to touch.
- This fireplace is red hot during use and can ignite flammables too close to the burner. Keep flammables at least two feet from sides & eight feet from top. Keep gasoline and other flammable liquids and vapors well away from fireplace.
- The propane tank must always be stored outdoors in a well ventilated space. Never store propane tank in an enclosed area (house, garage, etc.). If fireplace is to be stored indoors, disconnect the propane tank for outdoor storage.

## ⚠ WARNING



### • BURN HAZARD

- Never leave fireplace unattended when hot or in use.
- Keep out of reach of children.

## ⚠ CAUTION

### • SERVICE SAFETY

- Keep all connections and fittings clean. Make sure propane tank valve outlet is clean.
- Inspect hose before use. Replace if there is evidence of abrasion or wear.
- During set up, check all connections and fittings for leaks using soapy water. Never use a flame.
- Use as a heating appliance only. Do not use for cooking. Never alter in any way or use with any device or part not expressly approved by Coleman.
- Never burn wood or other fuels with this appliance.

## Assembly

**TOOLS REQUIRED:** A standard Phillips head screwdriver is the only tool required for assembly (not provided).

### Step 1

- Remove all components from package.



- Loosely install support brackets to base.



- Insert tab into slot.
- Install top screw as shown.



**Step 1 (cont)**

■ Install two cover pieces to base.



**Step 2**

■ Install top support ring between cover and support brackets.



**Step 3**

■ Place collar ring in position as shown.



■ Load fire pan assembly.



NOTE: Make sure no wires are pinched between fire pan and support ring.

■ Install 3 Phillips Head screws through support ring in location shown. Tighten screws.

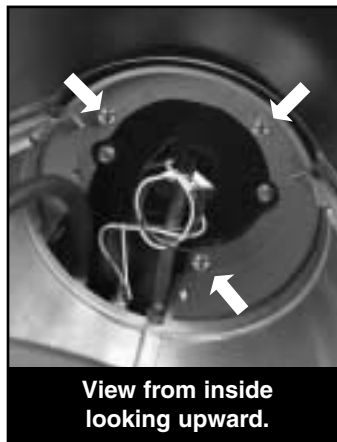
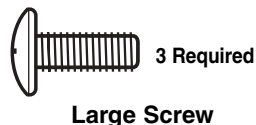

■ Unit is now ready for final assembly.



**Step 4**

■ Install log center piece.



■ Install log support ring so that "A" is to the front of the unit (Control Panel side).

■ Notches in Support Ring must match Electrodes on Burner.

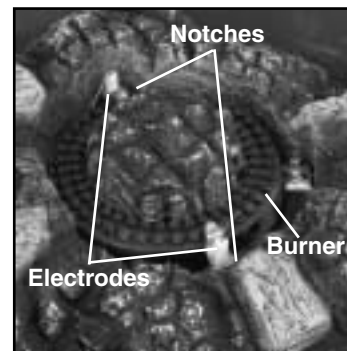

■ Logs are marked A, B, C, D, E, which match markings on log support ring.

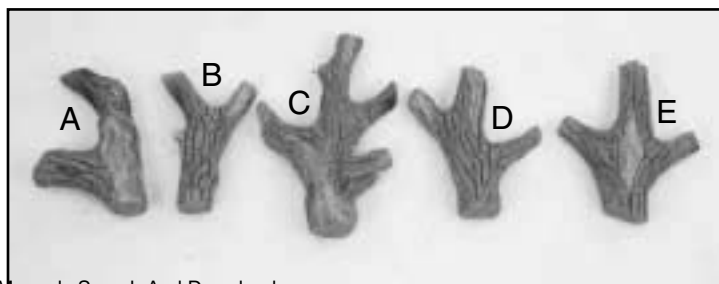

**Step 4 (cont)**

■ The support ring and each log is marked with a Letter which corresponds to the location where logs should be placed. Each log also has recesses that are lettered which indicate where adjoining logs are to be placed. Start with log "A" then "B", etc.

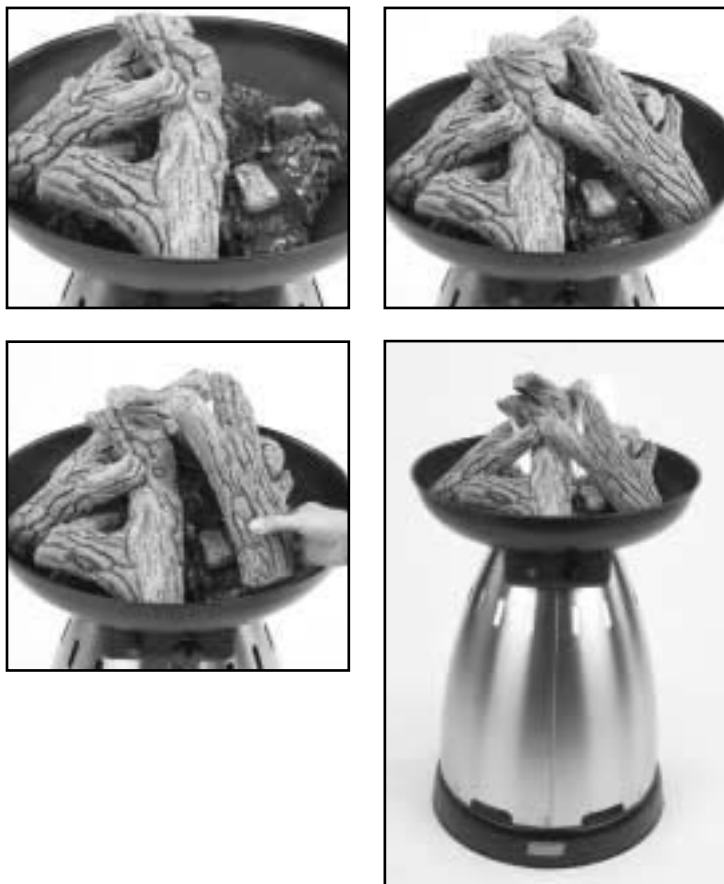

**Step 5**

- You must provide propane gas and propane tank. Use a standard 20 lb. propane tank only. The L.P. cylinder must have a shut-off valve terminating in a Type 1 L.P. gas cylinder valve outlet.
- Use this fireplace only with a propane vapor withdrawal supply system. See Chapter 5 of the *Standard for Storage and Handling of Liquefied Petroleum Gas, ANSI/NFPA 58*. Your local library or fire department will have this book.
- A minimum supply pressure of 11.0 W.C. is required for the purpose of input adjustment for propane gas.
- The pressure regulator and hose assembly supplied with the fireplace must be used.
- The installation must conform with local codes, or in the absence of local codes, with National Fuel Gas Code, ANSI Z223.1.
- A dented, rusted or damaged propane tank may be hazardous and should be checked by your tank supplier. Never use a propane tank with a damaged valve connection.
- The propane tank must be constructed and marked in accordance with the specifications for LP gas cylinders of the U.S. Department of Transportation (DOT).
- Never connect an unregulated propane tank to the heater.



Standard 20 lb. tank

**Step 5 (cont)**

■ Attach regulator to tank.



■ Install tank.



**Leak Check**

**⚠ WARNING**

- Perform leak test outdoors.
- Extinguish all open flames.
- NEVER leak test when smoking.
- Do not use the fireplace until connection has been leak tested and does not leak.

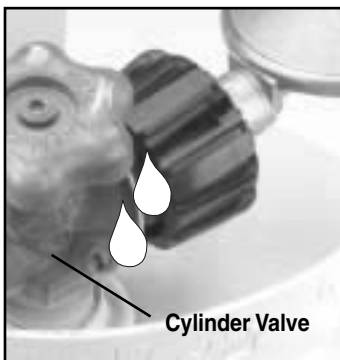

Cylinder Valve

**Regulator/Cylinder Connection**

- Make 2-3 oz. of leak check solution (one part liquid dishwashing detergent and three parts water).
- Apply several drops of solution where regulator connects to Cylinder.
- Make sure control knob is OFF.

- Turn Cylinder Valve ON.
- **If bubbles appear at connection, there is a leak.**
- Turn Cylinder Valve OFF.
- If leak is at Regulator/Cylinder Valve connection: disconnect, reconnect, and perform another leak check. If you continue to see bubbles after several attempts, cylinder valve is defective and should be returned to cylinder's place of purchase.

**If NO bubbles appear at connection, the connection is secure.**

- Turn Cylinder Valve OFF.

**NOTE: Whenever gas connection is loosened or removed, you must perform a leak test.**



Control Knob

## ⚠ DANGER



### • CARBON MONOXIDE HAZARD

- For outdoor use only. Never use inside house, or other unventilated or enclosed areas. This fireplace consumes air (oxygen). Do not use in unventilated or enclosed areas to avoid endangering your life.

## ⚠ DANGER



### • EXPLOSION - FIRE HAZARD

- Never store propane near high heat, open flames, pilot lights, direct sunlight, other ignition sources or where temperatures exceed 120 degrees F (49°C).
- Propane is heavier than air and can accumulate in low places. If you smell gas, leave the area immediately.
- Never install or remove propane tank while fireplace is lighted, near flame, pilot lights, other ignition sources or while fireplace is hot to touch.
- This fireplace is red hot during use and can ignite flammables too close to the burner. Keep flammables at least two feet from sides & eight feet from top. Keep gasoline and other flammable liquids and vapors well away from fireplace.
- The propane tank must always be stored outdoors in a well ventilated space. Never store propane tank in an enclosed area (house, garage, etc.). If fireplace is to be stored indoors, disconnect the propane tank for outdoor storage.

• Do not attempt to operate until you have read & understand all General Safety Information in this manual and all assembly is complete & leak checks have been performed.

- Turn cylinder valve on.
- Install cover.

**Attention: It is not recommended that this appliance be used if winds are in excess of 10 mph.**



### Battery Installation

1. Unscrew red ignitor button to reveal battery compartment.
2. Install AA battery with positive (+) outward.
3. Replace ignitor button finger tight.



### Lighting Instructions for FIREPLACE

1. Push in and rotate (counter clockwise) control knob to the start position and release.



2. Push in on control knob and push Igniter knob until unit is lighted.



*Note: Initial lighting after gas cylinder change can take up to one minute to purge any air that may be in the line.*

3. Burner will ignite and be visible. Continue to push control knob in for 30 to 60 seconds and then release knob. Burner must remain on, if not return to Step 1.

**Warning:** Do not lean over appliance while attempting to light.

*Note: If burner fails to remain lighted, all valves should be closed and a waiting period of at least 5 minutes should pass before attempting to light.*



4. Rotate control knob to LOW or HIGH position as desired.

Burner may be lighted with match if needed. Recommended that a long fireplace match may be used.

### Shut Down Procedure

1. Rotate control knob (clockwise) to start position.
2. Push in on control knob and rotate (clockwise) to OFF position.
3. Turn LP bottle valve off.



### Storage

**Disconnect fireplace from propane tank before long term storage of either the cylinder or the fireplace.**

1. Turn cylinder valve off.
2. Disconnect regulator from cylinder.
3. Remove tank from fireplace.
4. Store propane tank in safe manner. Refer to Chapter 5 of *Standard for Storage and Handling of Liquefied Gases, ANSI/NFPA 58*. Follow all local codes. Always store propane tanks outdoors.
5. Store fireplace in a dry, clean, and safe place.

## ⚠ WARNING



### • BURN HAZARD

- Do not touch or attempt any maintenance on Heater for at least one hour after use.
- Make sure all controls are off and propane tank has been removed before doing maintenance.

### Maintenance

To enjoy years of outstanding performance from your fireplace perform the following maintenance activities on a regular basis:

- Keep exterior surfaces clean.
- Use warm soapy water for cleaning. Never use flammable or corrosive cleaning agents.
- While cleaning your unit, be sure to keep the area around the burner dry at all times.
- Air flow must be unobstructed. Keep controls, burner, and circulating air passages clean. Signs of possible blockage include:
  - Gas odor.
  - Fireplace makes popping noises.
  - Smoky flame.
- Spiders and insects can nest in burner orifices. This condition can damage fireplace and render it unsafe for use. Clean burner holes by using a heavy-duty pipe cleaner. Compressed air may help clear away small particles.
- Carbon deposits may create a fire hazard. Clean burner with warm soapy water if any carbon deposits develop.
- Carbon may form on logs. If this occurs carbon can be removed with warm soapy water or a soft bristle brush.
- If fireplace has been left uncovered and is wet from rain, snow, yard sprinklers, etc., allow to dry (at least 30 minutes prior to use).
- NOTE: In a salt-air environment (such as near an ocean), corrosion occurs more quickly than normal. Frequently check for corroded areas and repair them promptly.

## Troubleshooting

Problem	Possible Cause	Solution
<b>Burner won't light</b>	Cylinder valve is closed	Open valve
	Gas pressure is low	Turn Cylinder valve OFF and replace cylinder
	Air in gas line	Burner may take 1-2 minutes to light after a propane bottle has been connected
	Low gas pressure with Cylinder Valve fully open	Cylinder is empty. Replace cylinder
	Igniter fails	Use match to light. Obtain new lighter and replace
	Control knob <b>not</b> fully depressed in start position when lighting burner	Depress control knob firmly in start position when lighting
<b>Burner won't stay lit</b>	Dirt built up around burner	Clean dirt from around burner
	Thermocouple is not operating correctly	Replace Thermocouple
<b>Burner flame is low</b> <small>NOTE: Do not operate fireplace below 0° F.</small>	Gas pressure is low	Turn Cylinder valve OFF and replace cylinder
	Outdoor temperature is less than 40° F and tank is less than 1/4 full	Use a full cylinder
	Supply hose is bent or kinked	Straighten hose
	Control knob not fully ON	Turn Control Knob fully on
	Burner or orifices blocked	Clean blockage from burner & orifices

## Service

- Repair to gas passages and associated components should be done only by a qualified service person.
- Owner repair & service should be limited and performed only to the following: - Log replacement - Cylinder replacement

## Warranty

### Coleman Limited 7-Year Warranty

Coleman will repair or replace, at its option, this product or any component found to be defective in materials or workmanship within seven years of the original retail purchase.

This warranty is valid for the original retail purchaser from the date of initial retail purchase and is not transferrable. Keep the original sales receipt. Proof of purchase is required to obtain warranty performance. Coleman dealers, service centers, or retail stores offering Coleman products do not have authority to alter, modify or in any way change the terms or conditions of this warranty.

#### WHAT IS NOT COVERED

- Cost of shipment to Coleman
- Normal wear and tear, including chips, scratches, abrasion, discoloration or fading from use or exposure to sunlight
- Damage caused by misuse, abuse, neglect, alterations, repairs by unauthorized persons, use of non-Coleman accessories or parts, or failure to follow recommended care or maintenance instructions
- Products used for commercial purposes or in profit or non-profit instructional or rental operations
- Mantles, generators, light bulbs, batteries or fuel
- CONSEQUENTIAL DAMAGES, INCIDENTAL DAMAGES, OR EXPENSES, INCLUDING DAMAGES TO PROPERTY. SOME STATES/PROVINCES DO NOT ALLOW THE EXCLUSION OR LIMITATION OF INCIDENTAL OR CONSEQUENTIAL DAMAGES, SO THE ABOVE LIMITATION OR EXCLUSION MAY NOT APPLY TO YOU.

#### IMPLIED WARRANTIES

Any implied warranties, either statutory or otherwise, including implied warranties of merchantability and fitness for a particular purpose, shall be limited to the duration and terms of the express warranties set forth in this limited warranty. Some states/provinces do not allow limitations on how long an implied warranty lasts, so the above limitation may not apply to you.

#### HOW TO OBTAIN WARRANTY PERFORMANCE

Take the product to an authorized Coleman Service Center. If one is not conveniently located, attach a tag to the product which includes your name, address, telephone number and description of the problem. Include a copy of the original sales receipt. Carefully package the product and send prepaid either by U.P.S. or Parcel Post, **insured** to: USA: The Coleman Company Inc., 3600 N. Hydraulic, Wichita, KS 67219, or CANADA: The Canadian Coleman Co., Ltd., 5975 Falbourne Street, Mississauga, Canada L5R 3V8. Please do not mail products with fuel in tanks, or with disposable propane cylinders. Remove glass globes from lanterns.

If you are located outside the United States or Canada, return this product to the place you purchased it, or to any other retailer seller of similar Coleman products, and request warranty assistance. If you are unable to obtain warranty assistance, then you may call any of the following Coleman offices for further assistance:

The Coleman Co., Inc.  
3600 N. Hydraulic  
Wichita, KS 67219 U.S.A.  
1-800-835-3278  
TDD: 316-832-8707

[www.coleman.com](http://www.coleman.com)



# Replacement Parts

## Parts List

No.	Part No.	Description
1	5076-5261	Burner
2	5076-1481	Electrode
3	5076-3231	Thermocouple
4	5076-1581	Hose
5	5076-5571	Valve Assembly (less hose)
6	5076-1491	Knob (valve)
7	5076-3211	Ignitor
8	5040-5251	Regulator
9	5076-1601	Log Set
10	5076-5311	Base
11	5076-3461	Door Panels, stainless steel (3 panels – model 5076-750 only)
	5076-3491	Door Panels, painted (3 panels – model 5076-751 only)
12	5076-5411	Bowl

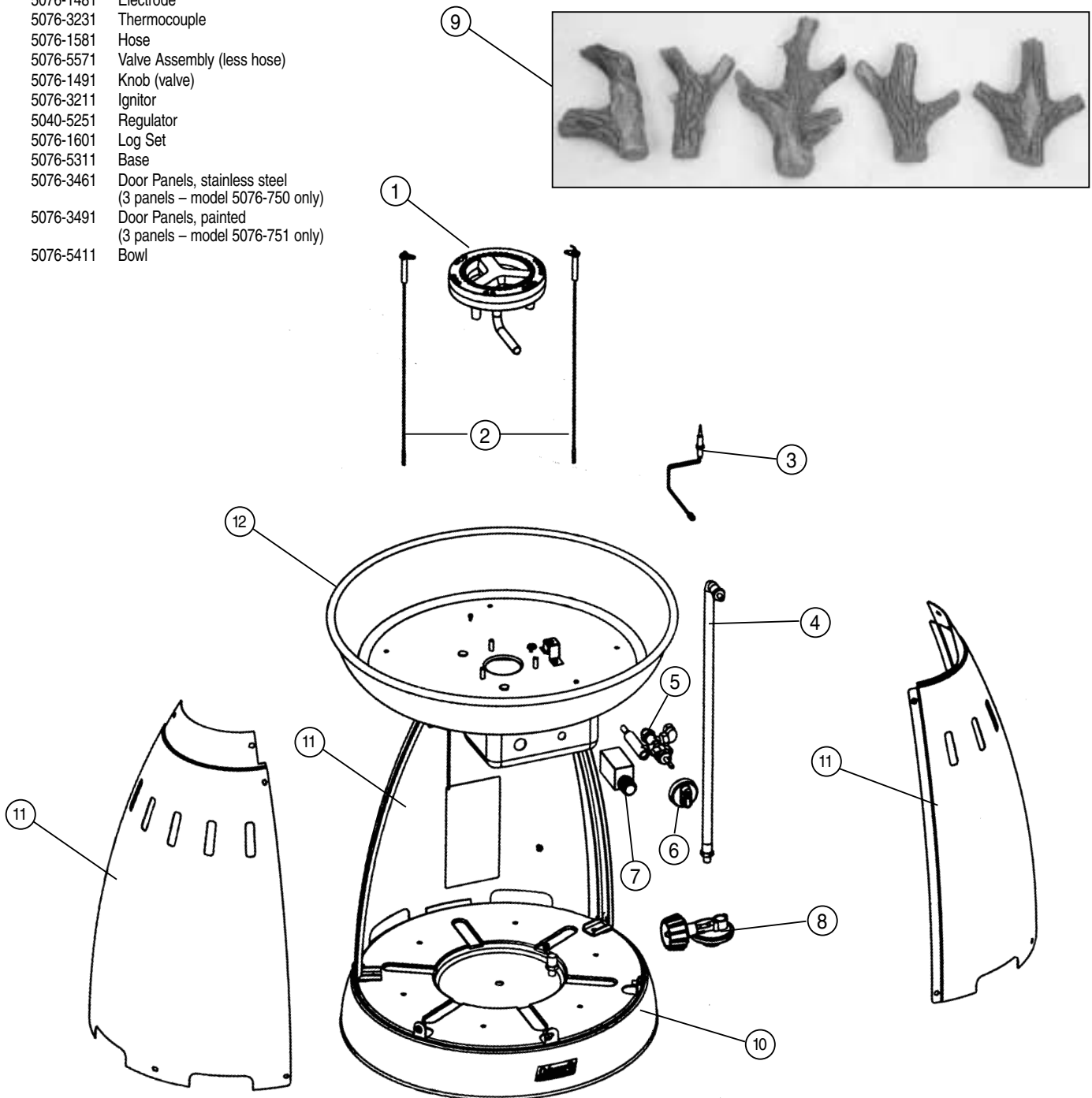

The Coleman Co., Inc.  
 3600 N. Hydraulic  
 Wichita, KS 67219 U.S.A.  
 1-800-835-3278  
 TDD: 316-832-8707



## Free Manuals Download Website

<http://myh66.com>

<http://usermanuals.us>

<http://www.somanuals.com>

<http://www.4manuals.cc>

<http://www.manual-lib.com>

<http://www.404manual.com>

<http://www.luxmanual.com>

<http://aubethermostatmanual.com>

Golf course search by state

<http://golfingnear.com>

Email search by domain

<http://emailbydomain.com>

Auto manuals search

<http://auto.somanuals.com>

TV manuals search

<http://tv.somanuals.com>