

American Standard

HERITAGE
AMARILIS

SINGLE-HOLE BAR/PANTRY FAUCET WITH SWING SPOUT

Installation Instructions
7100.2XX
7190.132

*Thank you for selecting American-Standard...
the benchmark of fine quality for over 100 years.*

*To ensure that your installation proceeds smoothly...
please read these instructions carefully before you begin.*

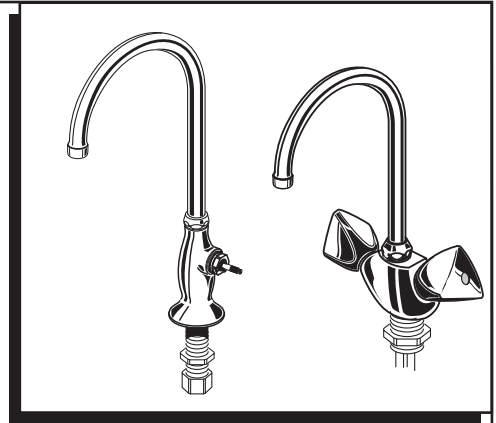

Certified to comply with ANSI A112.18.1M
U.S. Patent No. 5,819,789
34440 REV. 1.4

MODEL 7190.132

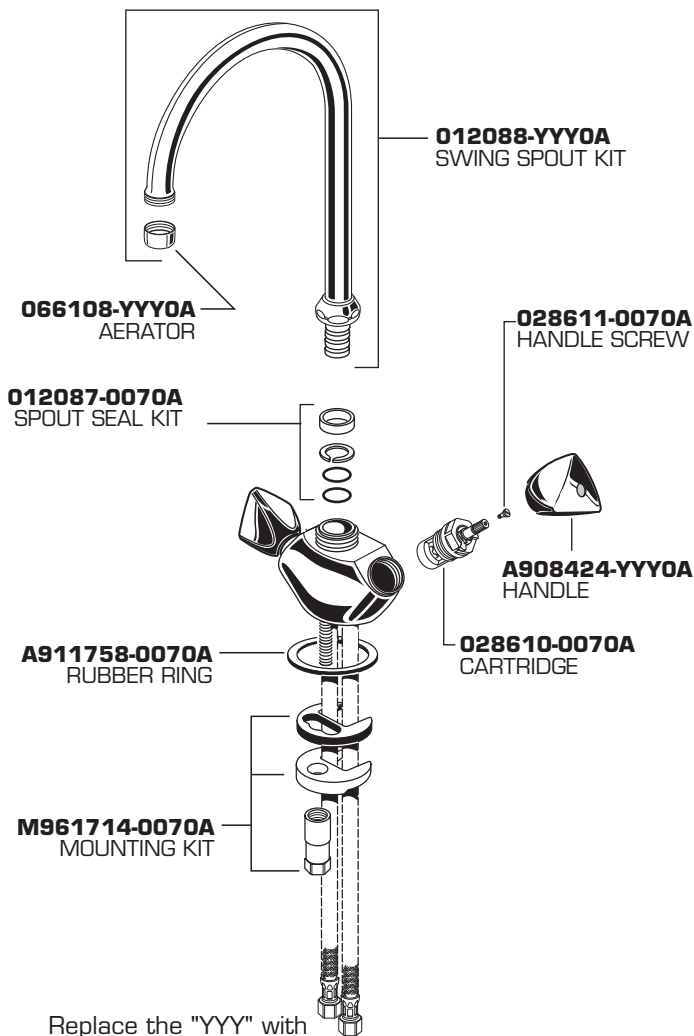

Replace the "YYY" with appropriate finish code

MODEL 7100.2XX

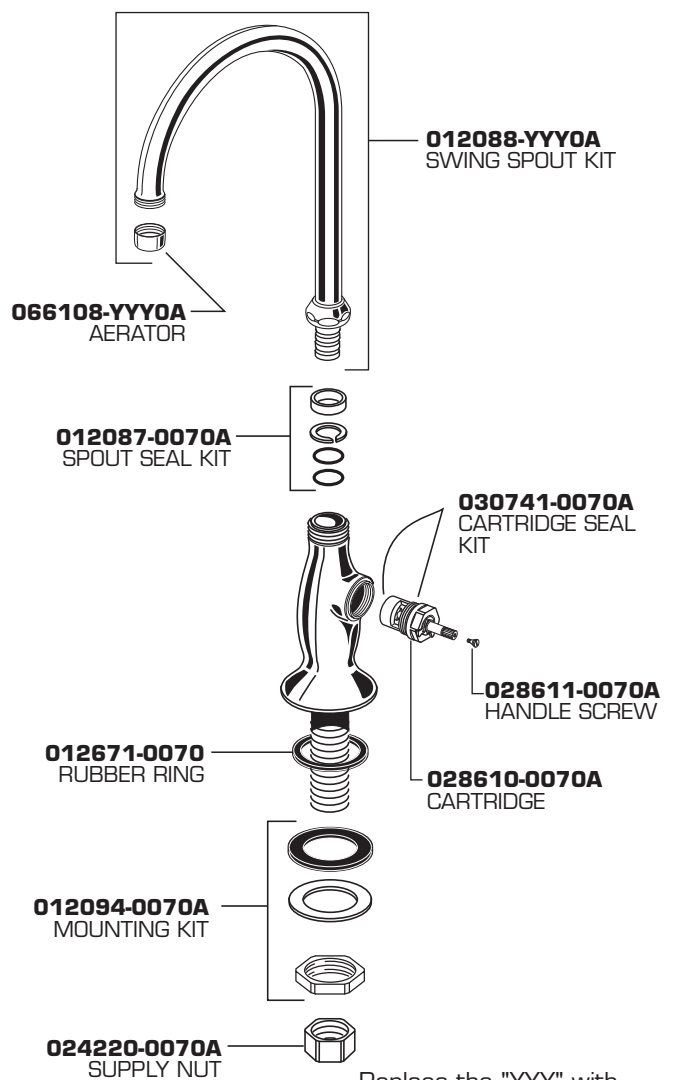

Replace the "YYY" with appropriate finish code

| | |
|-------------------|-----|
| CHROME | 002 |
| POL. BRASS | 099 |
| SATIN NICKEL | 295 |
| SATIN/BRASS | 297 |
| CHROME/POL. BRASS | 299 |



HOT LINE FOR HELP

For toll-free information and answers to your questions, call:
1-800-442-1902
Weekdays 8:00 a.m. to 6:00 p.m. EST
IN CANADA 1-800-387-0369 (TORONTO 1-905-306-1093)
Weekdays 8:00 a.m. to 7:00 p.m. EST
IN MEXICO 01-800-839-1200

Product names listed herein are trademarks of American Standard Inc.
© AS America, Inc. 2008

| | |
|------------|-----|
| CHROME | 002 |
| WHITE | 020 |
| BONE | 021 |
| POL. BRASS | 099 |

1

SWING SPOUT ASSEMBLY

CAUTION Turn off hot and cold water supplies before beginning.

- Assemble the SPOUT (3) and tighten the SPOUT NUT (4) until snug on VALVE BODY.

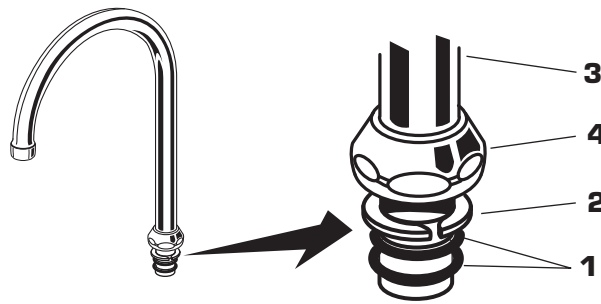

2

FITTING INSTALLATION

- Remove LOCKNUT (1), BRASS WASHER (2), and GASKET (3) from fitting.
- Place RUBBER RING (4) in recess of fitting.
- Insert inlet hoses (on model 7190.132 only) and THREADED SHANK through hole of sink making certain RUBBER RING (4) is properly seated in the recess of the fitting base.
- Assemble GASKET (3), BRASS WASHER (2), and LOCKNUT (1) onto the THREADED SHANK from underside of sink deck.
- Tighten the LOCKNUT (1) securely.

For Model 7190.132 Only

- Connect the hot water supply to the left inlet hose and the cold water supply to the right inlet hose using appropriate connectors.

For Model 7100.2XX Only

- Connect hot or cold water supply lines to shank using sealant, appropriate connectors, and coupling nuts.

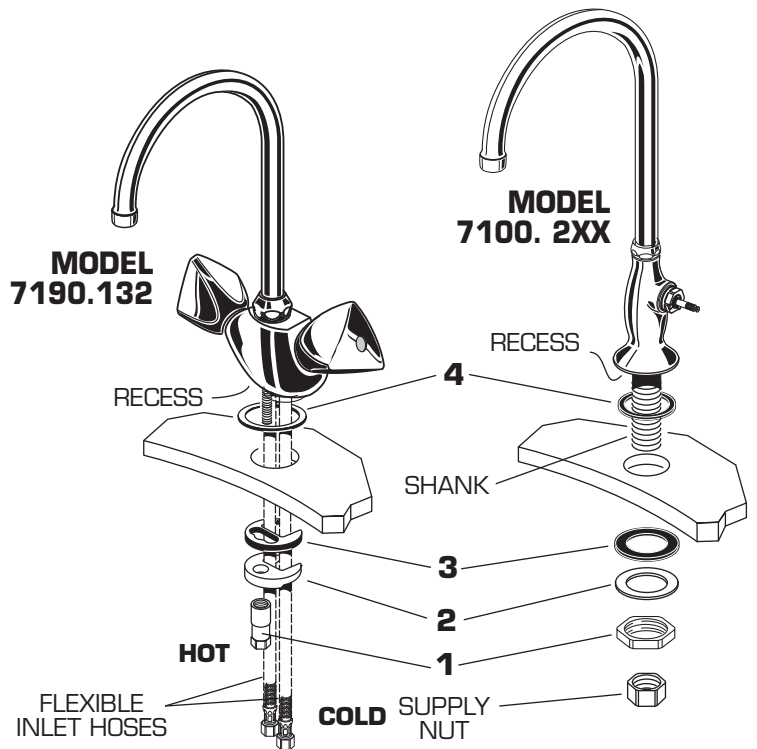

3

TEST INSTALLED FAUCET

- Remove AERATOR.
- With handle in OFF position, turn on water supplies and check all connections for leaks.

- Operate both handles to flush water lines thoroughly. Checkspout mounting and hose connections for leaks.
- Turn handles into OFF position and replace AERATOR.

4

SERVICE

- To change direction of handle rotation, proceed as follows:
 - Turn valve to OFF position.
 - Remove INSERT and HANDLE SCREW.
 - Slip HANDLE with ADAPTER off.
 - Remove SPRING CLIP (1).
 - Lift STOP WASHER (2), turn 90° and replace.
 - Replace SPRING CLIP (1).
 - Replace ADAPTER, HANDLE, SCREW, and INSERT.

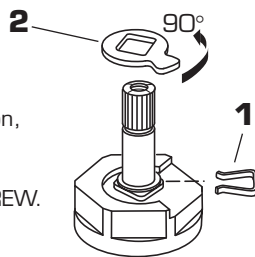

- AERATOR may accumulate dirt causing distorted and reduced water flow. Remove AERATOR and rinse clean.
- If spout drips, operate handles several times from OFF to ON position. Do not force - handles turn only 90°.
- Plastic SCREEN (3) in CARTRIDGE (4) may accumulate dirt causing reduced water flow. To clean, first turn off hot and cold water supplies, then:
 - Remove INSERT and HANDLE SCREW.
 - Slip HANDLE with ADAPTER off.
 - Unscrew CARTRIDGE (4) with wrench.
 - Thoroughly rinse plastic SCREEN (3) at base of CARTRIDGE (4).
 - Replace CARTRIDGE (4) until flange is tight against valve body.
 - Turn valves OFF.
 - Replace ADAPTER, HANDLE, SCREW, and INSERT.

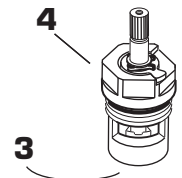

5

CARE INSTRUCTIONS:

DO: SIMPLY RINSE THE PRODUCT CLEAN WITH CLEAR WATER. DRY WITH A SOFT COTTON FLANNEL CLOTH.

DO NOT: DO NOT CLEAN THE PRODUCT WITH SOAPS, ACID, POLISH, ABRASIVES, HARSH CLEANERS, OR A CLOTH WITH A COARSE SURFACE.

Free Manuals Download Website

<http://myh66.com>

<http://usermanuals.us>

<http://www.somanuals.com>

<http://www.4manuals.cc>

<http://www.manual-lib.com>

<http://www.404manual.com>

<http://www.luxmanual.com>

<http://aubethermostatmanual.com>

Golf course search by state

<http://golfingnear.com>

Email search by domain

<http://emailbydomain.com>

Auto manuals search

<http://auto.somanuals.com>

TV manuals search

<http://tv.somanuals.com>