

What's in the box

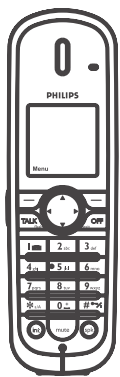
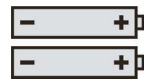
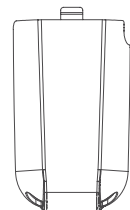

Handset

Two 750mAh
AAA NiMH
batteriesPower supply for
charger

Battery door

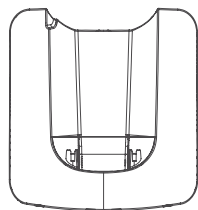

Charger

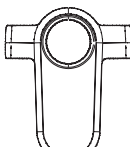

Belt clip



Quick start guide



User manual

What else will you need



A VOIP841

1 Connect

A Connect the charger

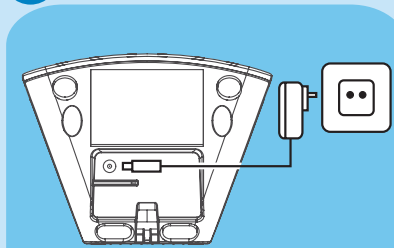

- Insert the plug of the charger power adapter into the socket on the bottom of the charger.
- Plug the power adapter into your power outlet.

B Insert batteries

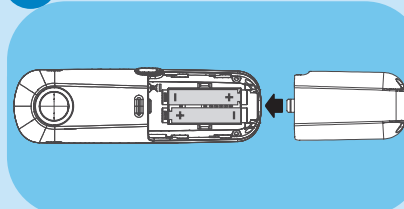

- Place the 2 rechargeable NiMH AAA batteries, observing their polarities, into the battery compartment on the handset.
- Slide the battery door firmly into place.

C Charge handset

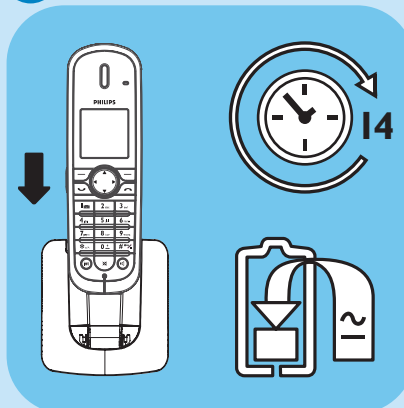

- Before first use, put the handset on the charger and charge batteries for 14 hours.

2 Install

A Register the handset

Registration allows communication between the base unit and handset(s). If the handset cannot communicate with its base, you will not be able to make any call or use many of the functions and features on the phone.

1. Press **Reg.**. Register shall be highlighted.
2. Enter the system PIN (Default: 0000). Use **Clear** to correct typing errors.
3. Press **Enter** to confirm.
 - Your handset starts searching for the base.
4. Press **(*)** on the base unit until the two indications turn off.
 - If registration is successful, the signal icon displays steadily.

Tip :

If registration failed, repeat the above procedure.

Note :

The base can register up to 4 handsets, then the base unit registration memory is full. If you attempt to register an additional handset, the registration process will be aborted.

B Verify the signal strength

The signal icon displays the link status between the handset and the base unit.

Signal icon : The handset and base unit are linked. They can communicate.

No signal icon : The handset and base unit have lost link. They are not able to communicate. Take your handset closer to the base unit to reconnect the link.

If you move too far away from the base unit while you are on the phone, you will hear warning tones notifying you that the handset is almost out of range - lost link. Take the handset closer to the base unit or your call will be cut off shortly after the warning.

Note :

If your handset has lost link, you will not be able to make or receive any call. In addition, you will not be able to carry out many of the phone functions and features.

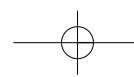

3

Enjoy

A Call another handset

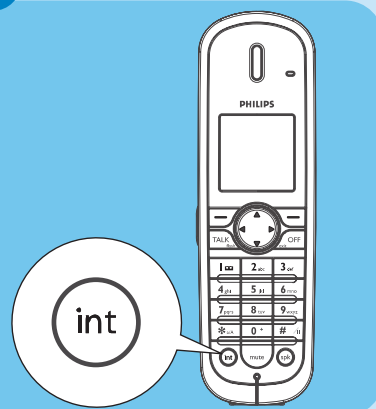

1. Press **int**.
2. Scroll to the handset you want to call.
3. Press **Call**.
 - Wait for the other party to answer your call.
4. Press **OFF** to cancel or end the intercom call.

B Answer a Skype/Landline call during an internal call

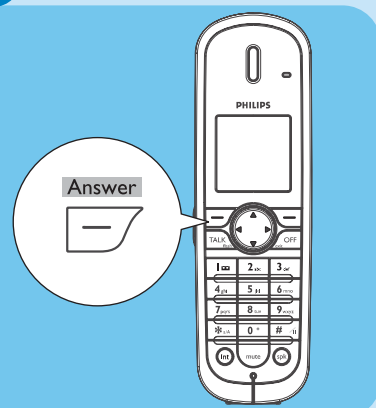

1. Press **Answer** to answer the incoming Skype call.
 - The internal call will be ended automatically.
2. Press **End** or **OFF** to end the Skype call.

C Call transfer

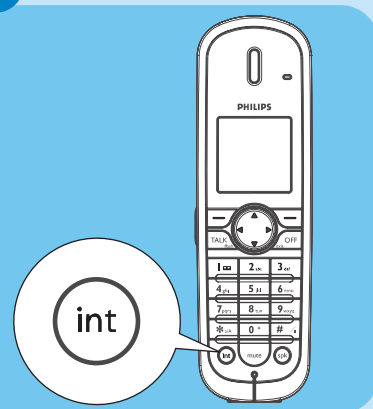

During a call in progress you can transfer the external call to a specific handset.

1. Press **int** during the call.
2. Scroll to the handset you want to call.
3. Press **Call**.
4. Press **OFF** after the other party answers your call.
 - The external call is now transferred to the other handset.

D Conference call

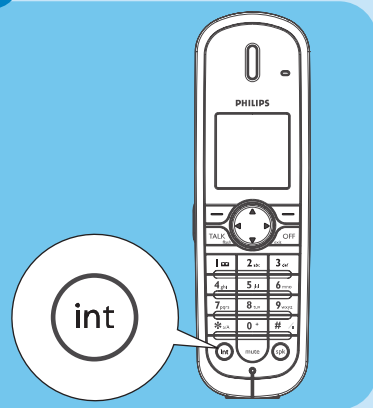

Conference call allows one external call to be shared with two handsets registered on the same base.

1. Press **int** during the call with the external caller.
2. Scroll to the handset you want to call.
3. Press **Call**.
 - Wait for the other party to answer your call.
3. Press **Conf.**.
 - You are now on a 3-way conference call.
4. Press **OFF** to end the conference call.

Welcome

Quick start guide

1 Connect

2 Install

3 Enjoy



WARNING Never use non-rechargeable batteries.

PHILIPS

Free Manuals Download Website

<http://myh66.com>

<http://usermanuals.us>

<http://www.somanuals.com>

<http://www.4manuals.cc>

<http://www.manual-lib.com>

<http://www.404manual.com>

<http://www.luxmanual.com>

<http://aubethermostatmanual.com>

Golf course search by state

<http://golfingnear.com>

Email search by domain

<http://emailbydomain.com>

Auto manuals search

<http://auto.somanuals.com>

TV manuals search

<http://tv.somanuals.com>