



Colour Television

32PW8521

Operating Instructions



PHILIPS



TABLE OF CONTENTS

Thank you for purchasing this television set. You are now the proud owner of a **PHILIPS** TV set which promises full value to you as a customer. Please read the instruction manual carefully and thoroughly to help you install and operate your TV set.

Introduction

Safety Information/Useful Tips	3
Before Calling Service	4

Basic Installation/Functions

Hooking Up Your TV (Basic Connection)	5
Use/Care of remote Control	5
Connecting the Audio/Video Sockets (Playback)	6
Connecting the Audio/Video Sockets (Recording)	8
Functions of Remote Control	9
Functions of TV Controls	11

TV Installation

Selecting the Menu Language and Automatic Tuning of Channels.....	12
Manual Tuning of Channels	14
Selecting the Colour/Sound System	15
Fine Tuning Of Channels	16
Sorting of Channels.....	17
Editing of Channels.....	18
Naming of Channels.....	19

Features

Using the Picture/Sound Menu.....	20
Using the Active Control Feature.....	21
Activating the Timer.....	22
Activating the Child Lock.....	24
Using the Screen Format	28
Using the Rotation Feature.....	29
Using the Blue Mute Feature.....	30
Smart Picture Control and Smart Sound Control.....	31
Using the Teletext.....	32

General

Specifications.....	34
---------------------	----



SAFETY INFORMATION AND USEFUL TIPS

Safety Information

- Disconnect mains plug when :
 - the red light below the TV screen is flashing continuously.
 - a bright white line is displayed across the screen.
 - cleaning the TV screen. Never use abrasive cleaning agents. Use a slight damp chamois leather or soft cloth.
 - there is a lightning storm.
 - the set is left unattended for a prolonged period of time.
- No naked flame sources, such as lighted candles, should be placed on top of the TV or in the vicinity.
- Do not place your TV set under direct sunlight or heat.
- Leave at least 5 cm around each side of TV set to allow for proper ventilation.
- Avoid placing your set (e.g. near the window) where it is likely to be exposed to rain or water.
- No objects filled with liquids should be placed on top the TV so as to avoid dripping or splashing of liquids on the set.

Useful Tips

- Do not leave your set on standby mode for a prolonged period of time. Switch off set to allow it to be demagnetised. A demagnetised set supports good picture quality.
- Do not shift or move the set around when it is switched on. Unevenness in colour in some parts of the screen may occur.
- Never attempt to repair a defective TV yourself. Always consult a skilled service personnel.



Recycling Directive – To minimise harm to the environment, the batteries supplied with the TV set do not contain mercury or nickel cadmium. If possible, when disposing of batteries, use recycling means available to you. Your TV set uses materials which are reusable or which can be recycled. To minimise the amount of waste in the environment, specialist companies recover used sets for dismantling and collection of reusable materials (contact your dealer).



BEFORE CALLING SERVICE

Below is a list of frequently occurred symptoms. Before you call for service, make these simple checks. Some of these symptoms can easily be rectified if you know what to do.

Symptom

What you should do

Colour patch
(unevenness)

- Switch off the TV by the mains power button. Wait for 20 minutes before switching on again.
- Check the TV is not placed too near speakers or magnetic objects.

No power

- Check the TV's AC power cord is plugged into the mains socket. If there is still no power, disconnect plug. Wait for 60 seconds and re-insert plug. Switch on the TV again.

No picture

- Check the antenna connection at the rear of the TV.
- Possible TV station problem. Try another channel.

Good picture
but no sound

- Try increasing the volume.
- Check that the sound is not muted. If it is muted, press the **Mute** button on the remote control to restore sound.

Good sound but poor
colour or no picture

- Try increasing the contrast and brightness setting.

Snowish picture and
noise

- Check antenna connection at the rear of the TV.

Horizontal dotted lines

- Possible electrical interference e.g. hairdryer, vacuum cleaner, etc. Switch off appliances.

Double images or
"Ghost" images

- Possible poor positioning of antenna. Using a highly directional antenna may improve reception.

TV not responding to
remote control handset

- Check life span of batteries of remote control handset.
- Aim remote control handset directly at remote control sensor lens on the TV.



HOOKING UP YOUR TV (BASIC CONNECTION)

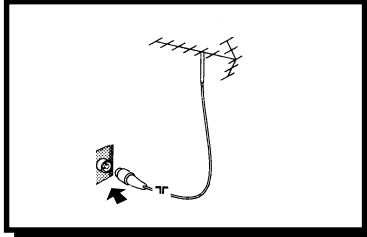

Antenna Connection

- Connect the aerial plug to the antenna socket **T** on the backcover.
- Insert the mains plug into the wall socket.

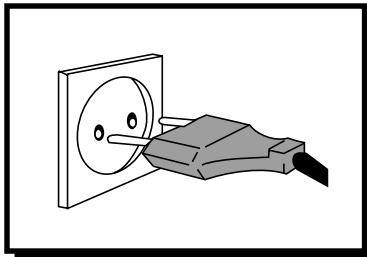

Mains Connection

- For correct mains voltage, refer to type sticker at the rear of the TV set
- Consult your dealer if mains supply is different.
Note : This diagram is not representative of the actual plug and socket.

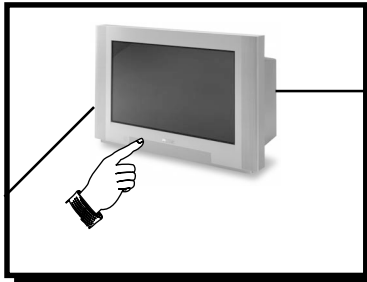

Switching on the Set

- Press the main power button to switch on/off the TV.
- If the set is on standby (indicator is red), press the **Power** button on the remote control to switch on set.

USE/CARE OF REMOTE CONTROL

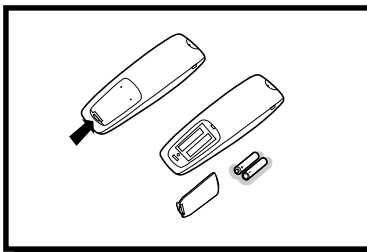

- Insert the correct type of batteries into the compartment.
- Ensure the batteries are placed in the right direction.



CONNECTING THE AUDIO/VIDEO SOCKETS (PLAYBACK)

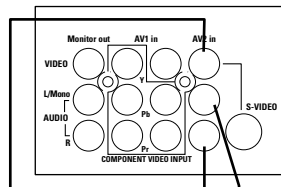

AV sockets
on rear of
TV

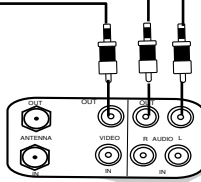

Back of
VCR



VCR (Equipped with
Video and Audio Output
sockets)

You can view the playback of VCR tapes (Video Disc players, camcorders, etc.) by using the **AUDIO** and **VIDEO INPUT** sockets on the rear of the TV.

- Connect the **VIDEO** and **AUDIO IN** sockets on the rear of the TV to the **AUDIO** and **VIDEO OUT** sockets on the VCR.

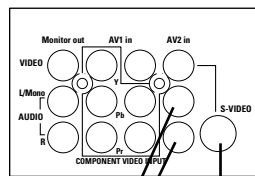

AV sockets
on rear of
TV

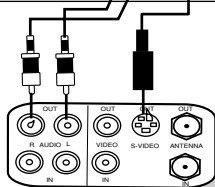

Back of S-VHS VCR



The S-Video connection on the rear of the TV is used for the playback of S-VHS VCR tapes, Video Discs, Video Games or Compact Disc-Interactive (cd-i) discs. Better picture detail and clarity is possible with the S-Video playback as compared to the picture from a normal antenna (RF) connection.

- Connect the **S-VIDEO** socket on the rear of the TV to the **S-VHS OUT** socket on a S-VHS VCR.
- Connect the **AUDIO IN** sockets from the rear of the TV to the **AUDIO OUT** sockets on the VCR.

Note : You need not connect the **VIDEO IN** socket of the TV if **S-VIDEO IN** socket is connected.





CONNECTING THE AUDIO/VIDEO SOCKETS (PLAYBACK)

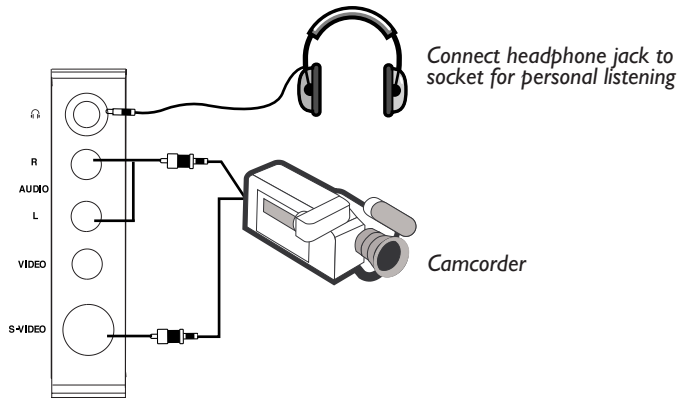

For more convenient direct playback connections, the Side Audio/Video Input sockets allow for quick and easy connections, particularly Camcorder tape recordings.

- Connect the **S-VIDEO** socket (if available) from the Camcorder to the Side **S-VIDEO** socket of the TV. You need not connect the Side **VIDEO IN** socket of the TV if the **S-VIDEO** socket is connected.
- Connect the **AUDIO OUT** sockets (Right and Left) from the Camcorder to the Side **AUDIO IN** sockets.

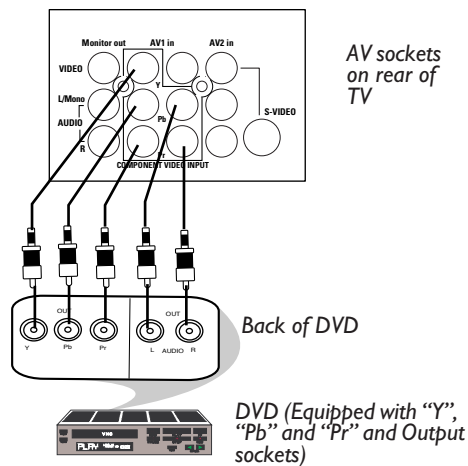

You can view the playback of DVD discs by using the **COMPONENT VIDEO INPUT** sockets on the rear of the TV.

- Connect the **"Y", "Pb" and "Pr" INPUT** sockets on the TV to the **"Y", "Pb" and "Pr" OUTPUT** sockets on the DVD to view playback of DVD discs.
- Note :** **"Y", "Pb", "Pr" sockets and AVI sockets cannot be connected simultaneously.**





CONNECTING THE AUDIO/VIDEO SOCKETS (RECORDING)

Connection for recording from the TV channel

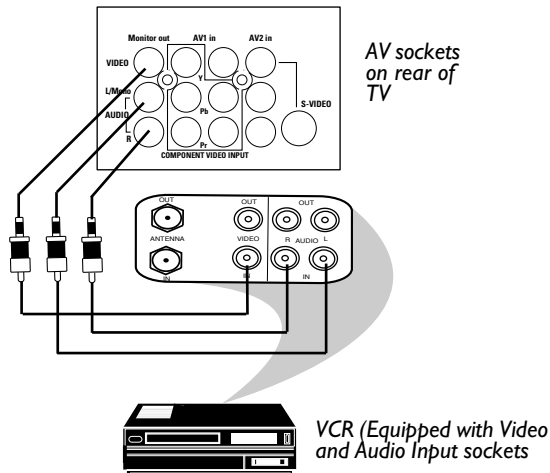

- Connect the corresponding **INPUT** sockets of the VCR to the **MONITOR OUTPUT** sockets on the rear of the TV.
- To enhance the sound of your TV, connect the **AUDIO L** and **R** sockets to an external audio system instead of the VCR. For mono equipment, connect only the **AUDIO L** socket.

Connection for recording from one VCR to another VCR

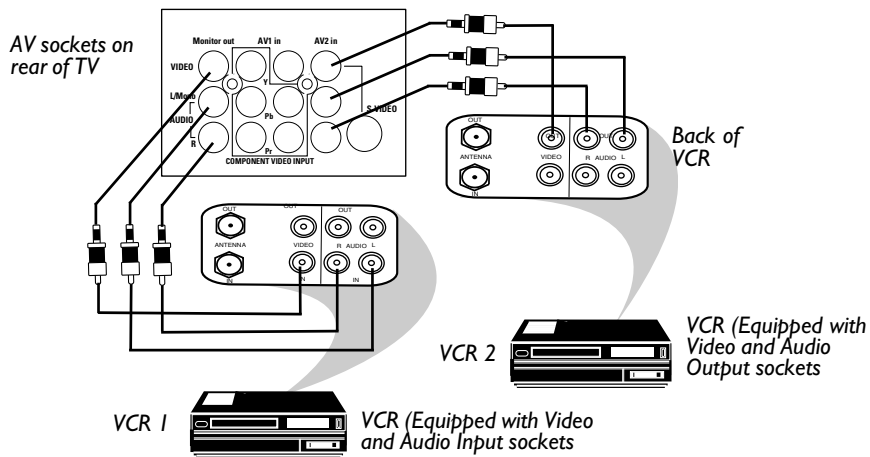

- Connect the sockets of the VCR which you wish to record from, to the corresponding sockets at either **AV1** or **AV2**.
- Connect the sockets of the receiving VCR to the **MONITOR OUTPUT** sockets on the rear of the TV.



FUNCTIONS OF REMOTE CONTROL

1 Power button

- Switch set off temporarily to standby mode. (The red light indicator lights up when the set is on standby mode).
- To switch on set from standby mode, press Channel +/- , Digit (0 -9) or Power button.

2 Teletext Colour buttons

- In teletext mode, the colour buttons allow you to access directly an item or corresponding pages.

3 Teletext buttons

Allows you to access teletext information. For detailed description of functions, refer to section on "Using the Teletext"

4 Smiley button

Not applicable.

5 Timer Button

Allows you to set the clock to switch to another channel at a specified time while you are watching another channel or when the set is on standby mode.

6 Smart Sound Button

Press the Smart Sound button repeatedly to access 4 different types of sound settings and choose your desired setting.

7 Menu Button

Displays the main menu. Also exits menu from screen.

8 Cursor Up Button

Allows you to select the next item on the menu.

9 Cursor Left Button

Allows you to select the sub-menus and adjust the settings.

10 Volume + / - Button

Increases or decreases volume.

11 II

Allows you to switch from Stereo to Mono sound during stereo transmission or to choose between language I or language II during dual sound transmission.

12 A/CH(Alternate channel) Button

Allows you to change between the current channel and the previous channel.

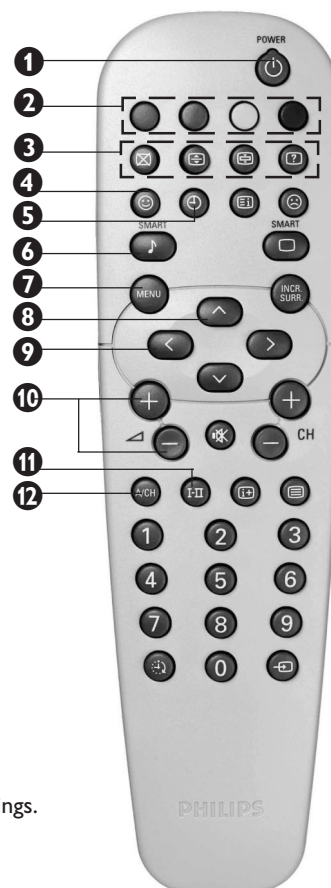



FUNCTIONS OF REMOTE CONTROL

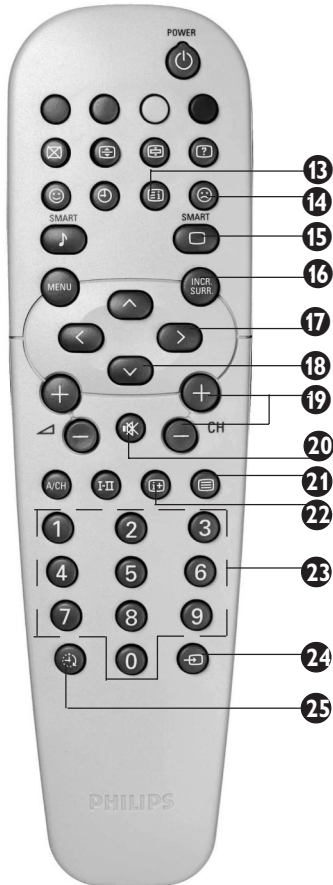

- 13 Main Index Button**
Not applicable.
- 14 Frownie button**
Not applicable.
- 15 Smart Picture Button**
Press the Smart Picture button repeatedly to access 5 different types of picture settings and choose your desired setting.
- 16 Incredible Surround Button**
 - Allows you to select Incredible Surround sound when transmission is in stereo mode.
 - Allows you to select Spatial Sound when transmission is in mono mode.
- 17 Cursor Right Button**
Allows you to access the sub-menus and adjust the settings.
- 18 Cursor Down Button**
Allows you to select the next item on the menu.
- 19 Channel + / - Buttons**
Allows you to select channels in ascending or descending order.
- 20 Mute Button**
Mutes sound. To restore sound, press button again.
- 21 Teletext Button**
Refer to section on “Using the Teletext”
- 22 OSD button**
Allows you to display the current channel number. It also allows to exit menu from the screen after control adjustments.
- 23 Digit (0 -9) Buttons**
Press to select a channel. For a 2-digit channel number, press the first digit and followed immediately by the second digit.
- 24 A/V Button**
Allows you to select the AV channels.
- 25 Sleeptimer Button**
Allows you to select a time period after which the set will switch to standby mode automatically.



FUNCTIONS OF TV CONTROLS

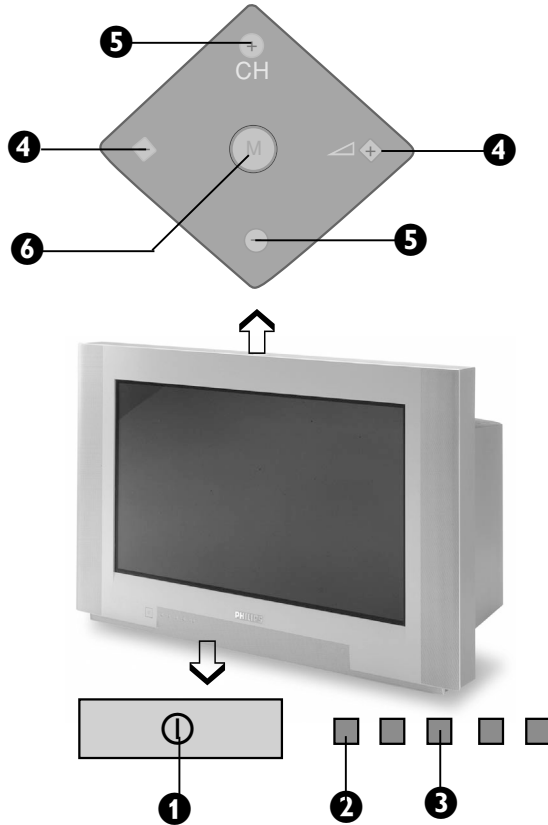

1	Mains Power button	Switch mains power on or off.
2	Standby Light indicator	Indicate red light when standby mode is activated.
3	Remote Sensor	Acts as a sensor for activating the controls of the TV when remote control handset is aimed at it.
4	Volume + / - button	Adjust sound volume louder/softer.
5	Channel + / - button	Select channel in ascending/descending order.
6	Menu button	Press the MENU button to enter main menu. Press the Channel + or - button to select the next item on the menu. Press the Volume + or - button to access the sub-menus and adjust the settings.

II





SELECTING THE MENU LANGUAGE AND AUTOMATIC TUNING OF CHANNELS

Operating instructions generally explains the operation of the TV set using the buttons on the remote control unless otherwise stated. Please read the following instructions carefully and follow the steps as shown to familiarise yourself with the installations and all features available in your set.

Before you tune in the channels by the **AUTO STORE** method, select the menu language of your choice. The **LANGUAGE** feature allows you to set the TV's on-screen menu to be shown in your desired language.

Step

Press button

Result on screen

1



Enter main menu.

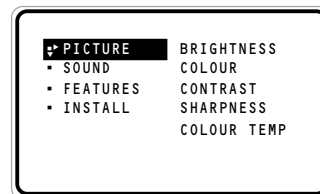

2



Press button repeatedly until **INSTALL** is selected.

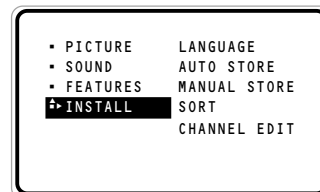

3



Enter **INSTALL** menu.





SELECTING THE MENU LANGUAGE AND AUTOMATIC TUNING OF CHANNELS

Step	Press button	Result on screen
4	Enter LANGUAGE mode.	
5	Select desired language. or 	
6	Exit from language mode.	
7	Select AUTO STORE .	
8	Start automatic tuning.	
9	When tuning is completed, exit menu from screen.	



MANUAL TUNING OF CHANNELS

Manual tuning allows you to store each programme manually.





Step	Press button	Result on screen
1	Enter main menu.	
2	Press button repeatedly until INSTALL is selected.	
3	Enter INSTALL menu.	
4	Press button repeatedly until MANUAL STORE is selected.	
5	Enter MANUAL STORE menu.	
6	Select SEARCH .	
7	Start manual tuning of channel. Searching stops once a transmitting channel is found.	
8	Select CHANNEL .	
9	Key in the desired channel number.	
10	Select STORE .	
11	Store tuned channel. Note : If you want to continue searching for another transmitting channel, repeat steps 7 to 11.	
12	Exit menu from screen.	



SELECTING THE COLOUR /SOUND SYSTEM

This feature allows you to select your desired **COLOUR** and **SOUND** system. If **AUTO** is selected, the respective colour and sound system will be automatically selected according to the transmission system.

Note : Select your desired colour and sound system manually if reception is poor at **AUTO** mode.

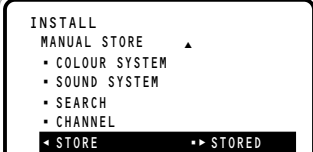
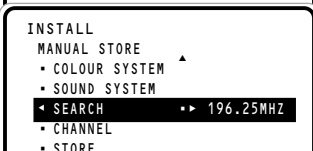
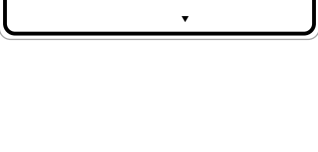
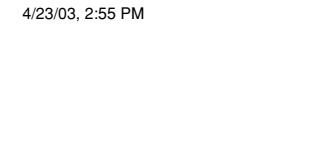
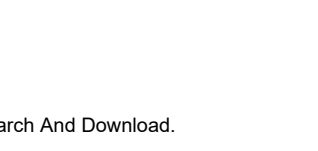
Step	Press button	Result on screen
Repeat step 1 to step 5 as in "MANUAL TUNING OF CHANNELS"		
6	> COLOUR SYSTEM is selected. Enter COLOUR SYSTEM mode.	
7	^ or v Select the desired colour system.	
8	< Exit from colour system mode.	
9	v Proceed to select SOUND SYSTEM .	
10	> Enter SOUND SYSTEM mode.	
11	^ or v Select the desired sound system.	
12	< Exit from sound system mode.	
13	v Press button repeatedly until STORE is selected.	
14	> Store selected system.	
15	⏏ Exit menu from screen.	



FINE TUNING OF CHANNELS

This feature allows you to adjust picture reception in areas of weak reception.

INSTALL

- ◀ LANGUAGE ▶ ENGLISH
- AUTO STORE B.MELAYU
- MANUAL STORE 中文
- SORT
- CHANNEL EDIT

1. Enter main menu. 2. Select **INSTALL**. 3. Enter install menu.

Step

Press button

Result on screen

4



Press button repeatedly until **MANUAL STORE** is selected.

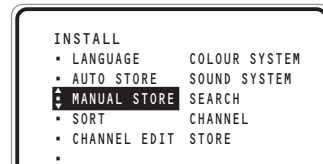

5



Enter **MANUAL STORE** menu.

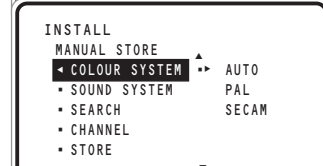

6



Press button repeatedly until **FINE TUNE** is selected.



7



or



Start fine-tuning until desired picture and sound is obtained.

8



Select **STORE**.



9



Store last fine-tuned status.

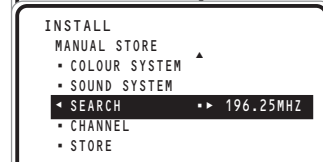

10



Exit menu from screen.



SORTING OF CHANNELS

This feature allows you to change the channel number to your choice for a particular TV station.

1. Enter main menu. 2. Select **INSTALL**. 3. Enter install mode.

Step

Press button

Result on screen

4



Press button repeatedly until **SORT** is selected.

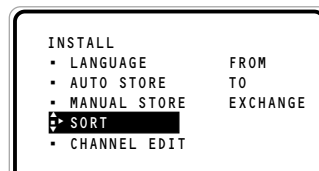

5



Enter **SORT** menu.



6



Key in the channel number in the **FROM** column, that is, the channel you want to swap from.

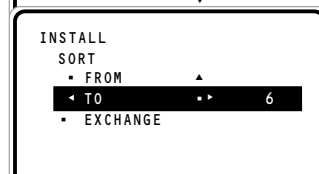

7



Select **TO**.

8



Key in the channel number in the **TO** column, that is, the channel you want to swap to.



9



Select **EXCHANGE**.

10



Activate exchange of channels.



11



Exit menu from screen.



EDITING OF CHANNELS

This feature allows you to edit or skip channels which have bad or weak TV signal or channels that you do not watch often.

Note : Once a channel is skipped, you cannot have access to it by the **CHANNEL +** or **-** button. You can only access the channel by the **DIGIT (0 -9)** button.

INSTALL ▲

◀ LANGUAGE ▶▶ ENGLISH

▪ AUTO STORE B.MELAYU

▪ MANUAL STORE 中文

▪ SORT

▪ CHANNEL EDIT ▼

1. Enter main menu. 2. Select **INSTALL**. 3. Enter install mode.

Step	Press button	Result on screen
4	▼	<pre> INSTALL ▲ ▪ LANGUAGE 3 ▪ AUTO STORE 4 ▪ MANUAL STORE 5 ▪ SORT 6 ◀ CHANNEL EDIT ▶▶ 7 </pre>
5	>	<pre> INSTALL ▲ ▪ LANGUAGE 3 ▪ AUTO STORE 4 ▪ MANUAL STORE 5 ▪ SORT 6 ◀ CHANNEL EDIT ▶▶ 7 </pre>
6	▲ or ▼	<pre> INSTALL ▲ ▪ LANGUAGE 3 ▪ AUTO STORE 4 ▪ MANUAL STORE 5 ▪ SORT 6 ◀ CHANNEL EDIT ▶▶ 7 </pre>
7	>	<pre> INSTALL ▲ ▪ LANGUAGE 3 ▪ AUTO STORE 4 ▪ MANUAL STORE 5 ▪ SORT 6 ◀ CHANNEL EDIT ▶▶ 7 SKIPPED </pre>
8	⊞	Exit menu from screen.

How to add back channels

- Repeat steps 1 to 5 as in “Editing of Channels”.
- Select the channel you want to add back by the ▲ (CURSOR UP) or ▼ (CURSOR DOWN) button.
- Press the > (CURSOR RIGHT) button to activate adding back of channel.
- Exit menu from screen by the ⊞ (OSD) button.



NAMING OF CHANNELS

This feature allows a selection of 10 channels of pre-defined names. It also allows you to enter a new name or modify an existing name of a channel for 40 channels including external channels.

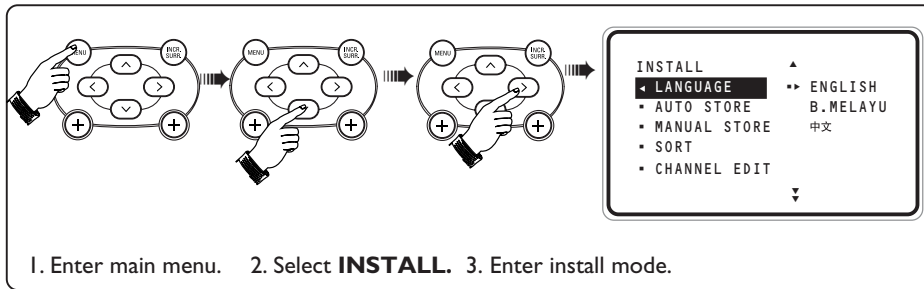

Step

Press button

Result on screen

4



Press button repeatedly until **NAME** is highlighted.



5



Enter **NAME** mode.



6



Select desired preset name and press **>** (**CURSOR RIGHT**) button to store selected pre-set name.



7



If you select **PERSONAL**, move to first character slot

8



Press button repeatedly to cycle through the characters and select desired character. Move to next character slot by the **>** (**CURSOR RIGHT**) button and select in the next character. (You can enter up to a maximum of 5 characters)

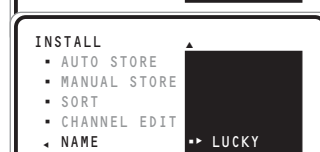

9



Store named channel.

10



Exit menu from screen.





USING THE PICTURE/SOUND MENU

The picture and sound menus allow you to make adjustments to the picture and sound. It also allow you to select and activate other features in the menu.

1. Press the **MENU** button to enter main menu.
2. Use the **CURSOR UP/DOWN** buttons to select the items on the **PICTURE/SOUND** menu.
3. Use the **CURSOR LEFT/RIGHT** buttons to access the sub-menus.

Picture menu items	Activities
Brightness	Increase or decrease brightness level.
Colour	Increase or decrease color level.
Contrast	Increase or decrease contrast level until lightest parts of the picture show good detail.
Sharpness	Increase or decrease sharpness level to improve detail in the picture.
Colour Temp	Allows you a choice of 3 picture settings (NORMAL, WARM and COOL).
* Digital Options	Allows you to choose from Auto, Digital Scan, Progressive Scan and 100Hz options.
Dynamic Contrast	Allows you a choice of 4 settings (Minimum, Medium, Maximum and Off) to boost the contrast level especially in dark scene so as to make the picture more noticeable.

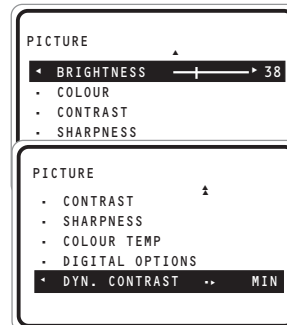

Note

HUE feature is only applicable to NTSC programmes. The **HUE** item will not appear on the menu if programme is in PAL mode.

* Digital Options

- **Digital Scan** option improves background flickering.
- **Progressive Scan** option reduces line flickering resulting in sharper picture.
- **100Hz** option is most appropriate for still pictures.

Note : Progressive Scan option is only available in NTSC transmission.

Sound menu items	Activities
Treble	Increase or decrease the high frequency level.
Bass	Increase or decrease the low frequency level.
Balance	Adjusts the balance of the right and left speakers' sound output.
AVL (Auto Volume Leveller)	As variation in signal conditions can result a sudden change in volume during in commercial breaks or channel switching, selecting the "ON" function will enable the volume to remain at a standard volume level.

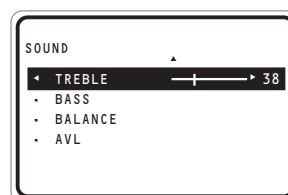

USING THE ACTIVE CONTROL FEATURE

This feature automatically adjust settings for optimal picture quality continuously under any signal conditions. To activate the Active Control feature, select the "ON" option in the Active Control menu.

How to access the Active Control function

1. Press the  (**MENU**) button to enter main menu and press the  (**CURSOR DOWN**) button repeatedly until **FEATURES** is selected.

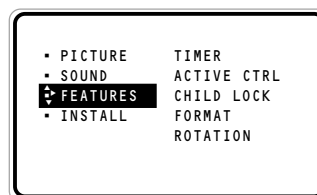

2. Press the  (**CURSOR RIGHT**) button to enter **FEATURES** menu.

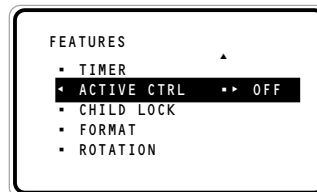

3. Press the  (**CURSOR DOWN**) button to select **ACTIVE CONTROL**.

4. Press the  (**CURSOR RIGHT**) button repeatedly to select **ON** option to activate the Active Control function.

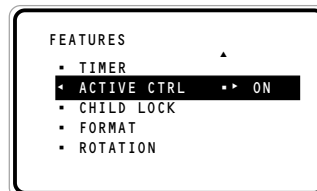

5. Press the  (**OSD**) button to exit menu from screen.



ACTIVATING THE TIMER

The Timer feature allows you to set the timer to switch to another channel at a specified time while you are watching another channel or when the TV is on standby mode.

Note : For the timer to function, the set must not be switched off. Once the set is switched off, the timer is disabled.

Step	Press button	Result on screen
1	Enter TIMER menu.	
2	Enter TIME mode.	
3	Key in the current time For example, if the current time is 12:30, key digit 1 and 2 in the hour column, followed by digit 3 and 0 in the minute column.	
4	Exit from TIME mode.	
5	Select START TIME .	
6	Enter the START TIME mode.	
7	Key in the time you want the programme to be switched on.	
8	Exit from START TIME mode.	
9	Select STOP TIME .	
10	Enter STOP TIME mode.	
11	Key in the time you want the programme to be switched off.	



ACTIVATING THE TIMER

Step	Press button	Result on screen
12	Exit from STOP TIME mode.	
13	Select CHANNEL .	
14	Key in the channel you want to switch to.	
15	Select ACTIVATE .	
16	Activate timer. You can select to activate timer by DAILY or ONCE mode.	
17	Select DISPLAY .	
18	Select ON mode if you want to display the current time on the TV screen.	
19	Exit menu from screen.	

Note

60 seconds before the timer is activated, a message indicating the time left for the channel switch will appear on the screen. To disable the channel switch, press any button on the remote control.



ACTIVATING THE CHILD LOCK (ACCESS CODE)

The Child Lock feature allows you to lock channels to prevent your children from watching programmes you deem undesirable.

Note : You cannot have access to the locked channels via the top controls of the TV set. You can only have access to the locked channels via the remote control. Keep the remote control out of reach so as to prevent your children from having access to it.

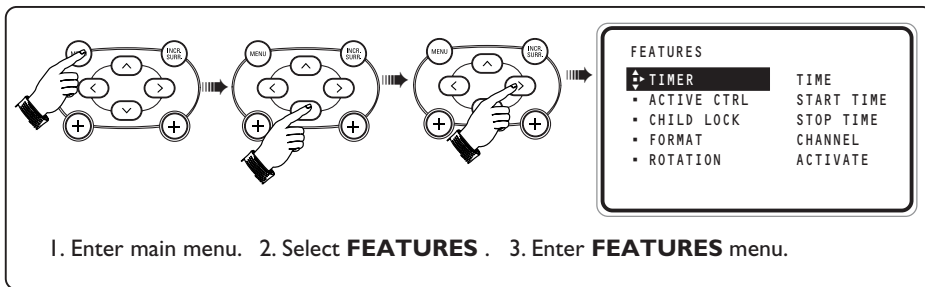

Step

Press button

Result on screen

4



Select **CHILD LOCK** .

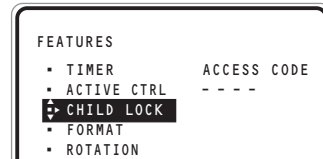

5



Enter **ACCESS CODE** mode.

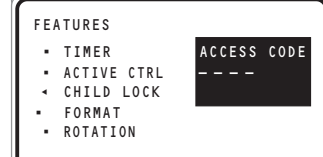

6



Key in access code **0711**
(0711 is the default access code).
A message **INCORRECT** will appear.

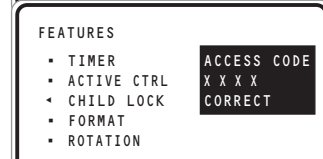

7





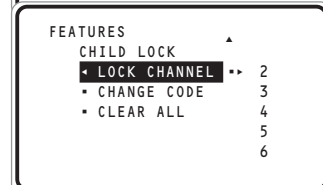





Key in **0711** the second time.
When the message **CORRECT**
appears, the **CHILD LOCK**
menu is now accessible.

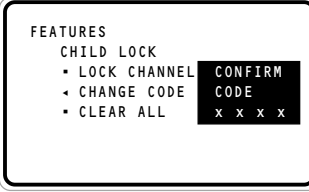
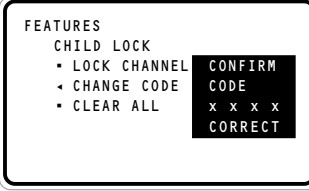

You can now proceed to change
the access code of your choice.

ACTIVATING THE CHILD LOCK (CHANGE CODE)

Step	Press button	Result on screen
8	 Select CHANGE CODE .	 <pre> FEATURES CHILD LOCK ▪ LOCK CHANNEL ENTER ▪ CHANGE CODE NEW CODE ▪ CLEAR ALL - - - - </pre>
9	 Enter CHANGE CODE mode.	 <pre> FEATURES CHILD LOCK ▪ LOCK CHANNEL ENTER ▪ CHANGE CODE NEW CODE ▪ CLEAR ALL x x x x </pre>
10	 Key in the access code of your choice.	 <pre> FEATURES CHILD LOCK ▪ LOCK CHANNEL ENTER ▪ CHANGE CODE NEW CODE ▪ CLEAR ALL x x x x </pre>
11	 Confirm access code.	 <pre> FEATURES CHILD LOCK ▪ LOCK CHANNEL CONFIRM ▪ CHANGE CODE CODE ▪ CLEAR ALL x x x x </pre>
	<p>When the new code is confirmed, the message CORRECT will appear.</p>	 <pre> FEATURES CHILD LOCK ▪ LOCK CHANNEL CONFIRM ▪ CHANGE CODE CODE ▪ CLEAR ALL x x x x CORRECT </pre>
12	 Exit menu from screen.	

Note : After you have exit menu from screen and you want to enter child lock menu again , you need to key the new access code only once. If you have forgotten the new access code, key in 0711 twice to enter the child lock menu. Upon entering the child lock menu, you can proceed to change code again.



ACTIVATING THE CHILD LOCK (LOCK CHANNEL)

FEATURES

- ▶ **TIMER** TIME
- ACTIVE CTRL START TIME
- CHILD LOCK STOP TIME
- FORMAT CHANNEL
- ROTATION ACTIVATE

1. Enter main menu. 2. Select **FEATURES**. 3. Enter **FEATURES** menu.

Step	Press button	Result on screen
4	▼	<p>Select CHILD LOCK .</p>
5	>	<p>Enter ACCESS CODE mode.</p>
6	1 2 3 4 5 6 7 8 9 0	<p>Key in access code .</p>
7	>	<p>Enter LOCK CHANNEL mode.</p>
8	▲ or ▼	<p>Select the channel you want to block.</p>
9	>	<p>Activate blocking of channel. A keylock symbol will appear beside the channel number indicating that it is locked.</p>
10	⏏	<p>Exit menu from screen.</p>

Note : You cannot have access to the locked channels via the top controls of the TV set. You can only have access to the locked channels via the remote control.

When AVI source is locked, CVI source is automatically locked. Like-wise, if CVI source is locked, AVI source is also automatically locked as they share the same audio input.

If you attempt to enter the **INSTALL** menu after locking a channel, a message "Enter **ACCESS CODE**" will appear on the screen. You need to enter the **ACCESS CODE** to enable you to enter the **INSTALL** menu.





ACTIVATING THE CHILD LOCK (CLEAR ALL)

To unlock channels that you have locked, enter the Child Lock menu and activate the **CLEAR ALL** mode.

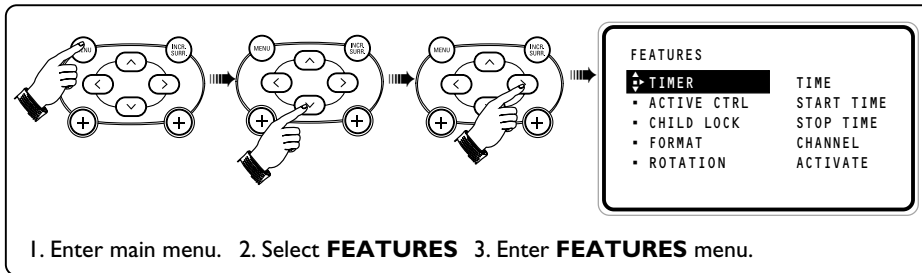

Step	Press button	Result on screen
4	Select CHILD LOCK .	<pre> FEATURES • TIMER ACCESS CODE • ACTIVE CTRL - - - - • CHILD LOCK - - - - • FORMAT • ROTATION </pre>
5	Enter ACCESS CODE mode.	<pre> FEATURES • TIMER ACCESS CODE • ACTIVE CTRL X X X X • CHILD LOCK CORRECT • FORMAT • ROTATION </pre>
6	Key in access code.	<pre> FEATURES • TIMER ACCESS CODE • ACTIVE CTRL X X X X • CHILD LOCK CORRECT • FORMAT • ROTATION </pre>
7	Press button repeatedly until CLEAR ALL is selected.	<pre> FEATURES CHILD LOCK ▲ • LOCK CHANNEL • CHANGE CODE • CLEAR ALL ► </pre>
8	Activate clearing of all locked channels.	<pre> FEATURES CHILD LOCK ▲ • LOCK CHANNEL • CHANGE CODE • CLEAR ALL ►►CLEARED </pre>
9	Exit menu from screen.	

Note

You can also unlock individual channel by the **LOCK CHANNEL** menu.

- Repeat **step 1** to **7** as in “**ACTIVATING THE CHILD LOCK (LOCK CHANNEL)**”.
- Select the channel you want to unlock by the or (**CURSOR UP / DOWN**) buttons.
- Press the (**CURSOR RIGHT**) button to unlock channel (the keylock symbol will disappear).





USING THE SCREEN FORMAT

Screen Format function allows you a choice of different formats for your viewing pleasure, namely : - **Auto, 4:3, Zoom 14:9, Zoom 16:9, Subtitle Zoom, Superwide** and **Widescreen**.

Enter the **FEATURES** menu and select **FORMAT** by the button. Press the or button to cycle through the various screen formats and select the format of your choice.

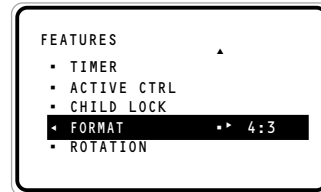

Definition of Screen Formats

AUTO mode

When **AUTO** format is selected, it will select the correct screen format provided the specific signals are transmitted with the programmes.

4:3 Mode

This picture is reproduced in 4:3 format and a black band is displayed on either side of the picture.

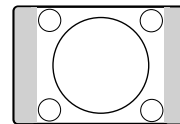

Zoom 14:9 Mode

This picture is enlarged to 14:9 format, a thin black band remains on both sides of the picture. The and buttons allow you to move the image up or down.

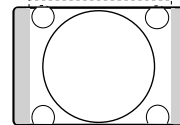

Zoom 16:9 Mode

This picture is enlarged to 16:9 format. This mode is recommended when displaying pictures which have black bands at the top and bottom (letterbox format). The and buttons allow you to move the image up or down.

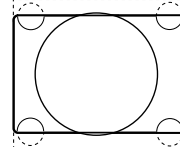

Subtitle Zoom Mode

This mode is use to display 4:3 pictures using the full surface of the screen leaving the subtitles visible. The and buttons allow you to move the image up or down.

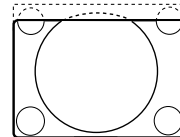

Superwide Mode

This mode is use to display 4:3 pictures using the full surface of the screen by enlarging the sides of the picture. The and buttons allow you to move the image up or down.

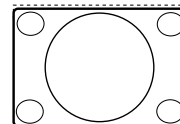

Widescreen Mode

This mode restores the correct proportions of pictures transmitted in 16:9 using full screen display. If you display a 4:3 picture in this mode, it will be enlarged horizontally.

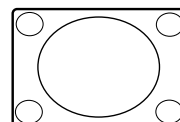



USING THE ROTATION FEATURE

Due to the earth's magnetic field and position of the TV set, slight tilting of the picture to the left or right may occur when the set is switched on. When this phenomenon occurs, select **ROTATION** in the **FEATURE** menu and adjust accordingly by the **Cursor Right** or **Left** button.

How to use the Rotation Feature

1. Press the **MENU** button to enter main menu and press the **CURSOR DOWN** button repeatedly until **FEATURES** is selected.
2. Press the **CURSOR RIGHT** button to enter **FEATURES** menu.
3. Press the **CURSOR DOWN** button repeatedly until **ROTATION** is selected.
4. Press the **CURSOR RIGHT** button when picture is tilted to the left. Press button until you deem picture is in normal position. If picture is tilted to the right, press the **CURSOR LEFT** button until you deem picture is in normal position.

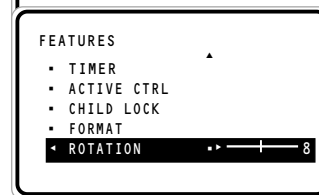
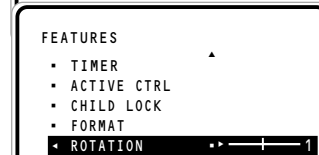
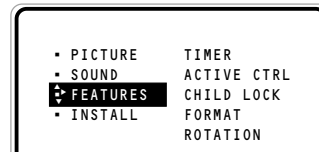

Picture tilted to the left



After adjustment



Picture tilted to the right



After adjustment





USING THE BLUE MUTE FEATURE

Blue Mute feature indicates to you the absence of signal when the TV screen turns blue. To activate the Blue Mute feature, select the “**ON**” option in the Blue Mute menu.

How to access the Blue Mute function

1. Press the  (**MENU**) button to enter main menu and press the  (**CURSOR DOWN**) button repeatedly until **FEATURES** is selected.

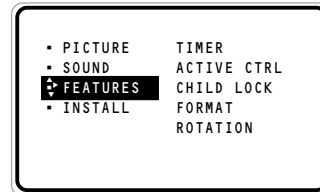

2. Press the  (**CURSOR RIGHT**) button to enter **FEATURES** menu.

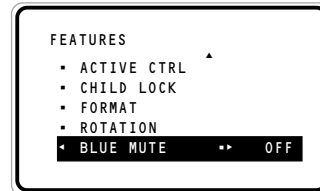

3. Press the  (**CURSOR DOWN**) button repeatedly until **BLUE MUTE** is selected.

4. Press the  (**CURSOR RIGHT**) button to select **ON** option to activate the Blue Mute function.

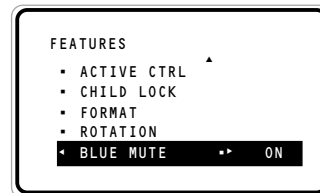

5. Press the  (**OSD**) button to exit menu from screen.



SMART PICTURE AND SMART SOUND CONTROL

SMART PICTURE feature offers you a choice of 5 picture settings, namely, **RICH**, **NATURAL**, **SOFT**, **PERSONAL** and **MULTIMEDIA**.

SMART SOUND feature offers you a choice of 4 sound settings, namely, **THEATRE**, **MUSIC**, **VOICE** and **PERSONAL**.

Press  (**SMART PICTURE**) or  (**SMART SOUND**) button repeatedly to cycle through the settings to select your desired mode.

Definition of Picture Settings

- PERSONAL** : Picture settings are set to your preference.
- RICH** : Emphasize very vibrant colours. (Suitable for AV mode in brightly-lit room)
- NATURAL** : Emphasize original colours.
- SOFT** : Emphasize "warm" colours. (Suitable for dimly-lit room condition and gives cinema-like effect when light is switched off).
- MULTIMEDIA** : Emphasize "soft" colours. (Suitable for playing computer games, surfing, etc.)

Note : The **PERSONAL** setting is the setting that you set up using the Picture menu in the main menu. This is the only setting in the Smart Picture settings that can be changed. All the other settings are pre-set at the factory.

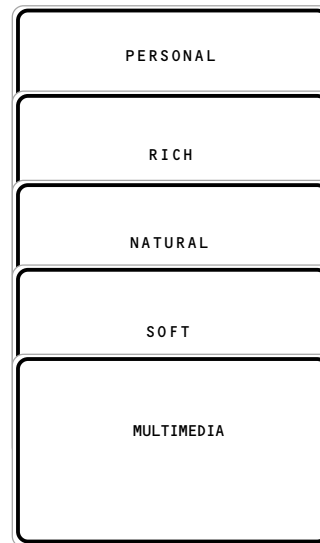

Definition of Sound Settings

- PERSONAL** : Sound settings are set to your preference.
- VOICE** : Emphasize high tone. (Treble boosted)
- MUSIC** : Emphasize low tone. (Bass boosted)
- THEATRE** : Emphasize sensation to action. (Bass and Treble boosted)

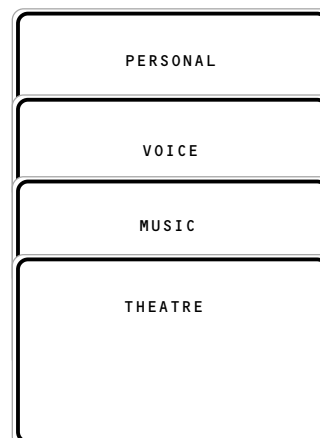



USING THE TELEXTEXT

If a TV channel broadcast contains teletext information, each channel that broadcasts teletext transmits a page (index page) with information on how to use the teletext system, usually on page 100. The system transmitted is indicated in the option line at the bottom of the screen.

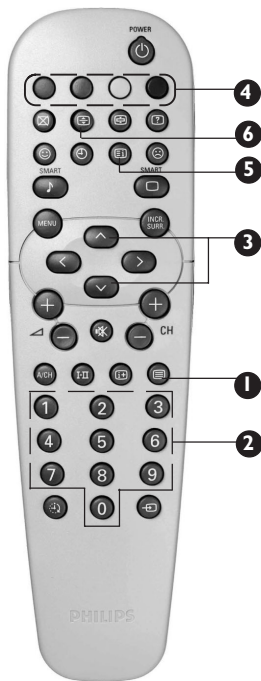

Press button

Result on screen

- 1 On/Off teletext and Superimpose teletext page over TV programme**

Press the button once to switch on teletext display. (A channel in which teletext is being transmitted must be selected).

Press the button the second time superimpose the teletext page over the TV programme.

Press the button the third time to exit teletext mode.

- 2 Selecting a teletext page**



Key in the required teletext page (3 digits). The page number is displayed at the top left hand corner of the screen. When the teletext page is located, the counter stops searching. If the counter keeps searching, it means that the page is not available for selection. If you make a mistake in keying the page number, you have to complete keying the 3-digit number before re-keying the correct page number.

- 3 Accessing a teletext page**



Press the **CURSOR UP** button to display the next page and the **CURSOR DOWN** button to display the previous page.

- 4 Direct Access to an item or corresponding pages**



The 4-colour buttons allow you to access directly an item or corresponding pages.

- 5 Main Index**



Not applicable.

- 6 Enlarge**



Press the button once to enlarge and view the top half of the page.

Press the button the second time to enlarge and view the bottom half of the page. Press the button the third time to return to normal size page.







USING THE TELETEXT







Press button

Result on screen

7 Hold 	Not applicable.
8 Interrupt 	Not applicable.
9 Selecting a sub-page  	For a teletext page with sub-pages, press the Cursor Left or Right button to access the previous sub-page or the next subpage.
10 Reveal/Conceal 	Press the button once to reveal hidden information (solutions to puzzles, riddles, etc). Press the button the second time to conceal information. This button is applicable only to teletext page with puzzles, riddles, etc.)

How to select your favourite page

This feature allows you select 4 of your favourite or most commonly viewed page and stored them in the favourite page selection. You can then access directly your favourite page by the colour buttons without having to key in the page number.

1. Press the  **TELEXTEXT ON/OFF** button to enter teletext mode.
2. Press the  **(MENU)** button to enter favourite page selection. **Note** : The colour alphabets at the bottom of the screen is now changed to page numbers.
3. Key in your favourite page by the  **(DIGIT 0 -9)** buttons.
4. Press the  **(OSD)** button to highlight pager numbers.
5. Select the colour button on your remote control you want your favourite page to be stored.
6. Repeat **step 3 to 5** to select and store other favourite pages.



SPECIFICATIONS

	32PW8521
Picture tube screen size	82 cm
Picture tube visible area	76 cm
Audio Output : Speaker Subwoofer	2 x 10 W 10W
TV System	NTSC M PAL B/G PAL D/K PAL I SECAM B/G SECAM D/K SECAM K I
Playback System	NTSC 3.58, NTSC 4.43, PAL 60
Set Dimensions : Width Depth Height	88.6 cm 53.3 cm 57.0 cm
Net Weight of Set (approximate)	54 kg

Note

For Operating Voltage, Frequency, Power Consumption and Version Number, refer to the type number at the rear of the set.



3139 125 31201



8521/Eng/69R/79Rp32-35

35



4/23/03, 3:00 PM



Free Manuals Download Website

<http://myh66.com>

<http://usermanuals.us>

<http://www.somanuals.com>

<http://www.4manuals.cc>

<http://www.manual-lib.com>

<http://www.404manual.com>

<http://www.luxmanual.com>

<http://aubethermostatmanual.com>

Golf course search by state

<http://golfingnear.com>

Email search by domain

<http://emailbydomain.com>

Auto manuals search

<http://auto.somanuals.com>

TV manuals search

<http://tv.somanuals.com>